

WESTERN MUSEUMS ASSOCIATION'S
ANNUAL MEETING

TUCSON
ARIZONA

SEPT
25-28
2024



BALANCE

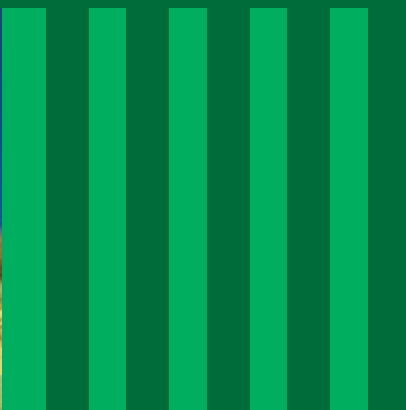

PRELIMINARY
PROGRAM



FINDING

BALANCE

Take some time to slow down and connect with nature.

The strategies on these pages invite you to breathe, engage your senses, and immerse yourself in the spaces around you.

FIND A QUIET PLACE

Find a quiet place to sit alone outdoors. Take at least 15 minutes.

Notice your breathing. You might even take some slow, deep breaths, if that is comfortable for you.

CONFERENCE CONNECTION:

Whenever you need a moment to reset, just pause and breathe.



agave

CONNECT WITH YOUR SENSES

Find a place outdoors to rest, maybe at a bench or area to sit.

Connect with each of your senses to learn more about this place: what does it sound like? look like? feel like? smell like?

Try this again in a new location. What do you notice that is different?

TAKE A SLOW NATURE WALK

Find a nearby walking path or trail outdoors to go for a slow nature walk.

The goal is not to go far, but rather to engage more deeply with everything around you in a very short distance.

How might this feel different than the typical pace of life?

Are there things you notice that you might have missed if you had not slowed down?

CONFERENCE CONNECTION:

Find a moment during the conference to practice slowing down.

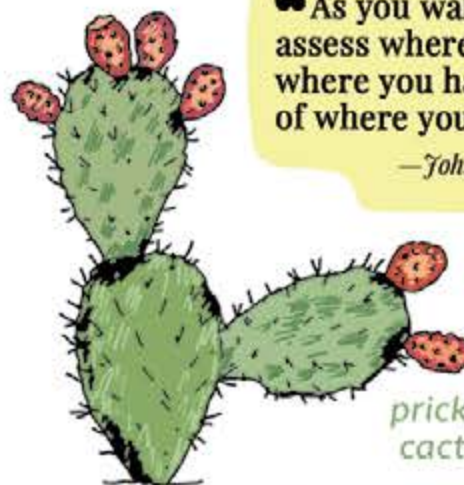

prickly pear cactus

“As you walk, look around, assess where you are, reflect on where you have been, and dream of where you are going.”

—John Francis, environmentalist

“Study nature, love nature, stay close to nature. It will never fail you.”

—Frank Lloyd Wright, architect

GO FOR A COLOR WALK

Explore a nearby path or trail, and choose one color to look for (in nature and in the human-made world).

Where can you find this color?

Did you notice this color more (or less) than you expected?

Try it again with a different color.

CONFERENCE CONNECTION:

Bring this keen sense of observation and intentional looking to your conference experience. What are some things you notice that you didn't before?

PRACTICE LISTENING

As you explore nearby nature paths or trails, take a moment to close your eyes and listen carefully to the sounds around you.

What do you hear that might be farthest from you?

What sounds might be closest to you?

CONFERENCE CONNECTION:

How might you bring this type of deeper listening into your conference experience? Are there ways you could be listening more deeply to others?



desert marigold

“Those who contemplate the beauty of the earth find reserves of strength that will endure as long as life lasts.”

—Rachel Carson, biologist & writer

palo verde

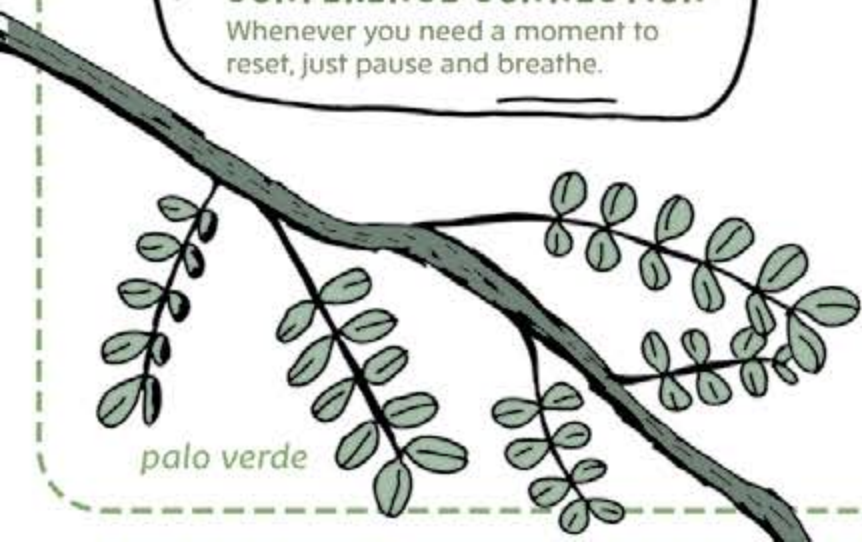



INVITATION

The Western Museums Association (WMA) warmly invites you to the 2024 Annual Meeting in Tucson, Arizona on September 25-28, produced in partnership with the Museum Association of Arizona and the Museum Trustee Association. Tucson, home to Tohono O’odham and the Pascua Yaqui, is situated in the Sonoran Desert and nestled between five mountain ranges: the Santa Catalina Mountains, the Tortolita Mountains, the Santa Rita Mountains, the Rincon Mountains, and the Tucson Mountains. The second largest metropolis in Arizona, Tucson is a UNESCO City of Gastronomy and a cultural and natural hub of the Southwest.

With the theme of **BALANCE, WMA 2024** will explore ideas of stability at both an individual and institutional level. Join us in Tucson to engage with fellow practitioners, participate in enlightening sessions, and delve into informal educational activities. With six session tracks, exciting events, and informal discussions, you won’t want to miss this dynamic conference that showcases an array of perspectives and provides multifaceted learning opportunities for professionals, regardless of cultural institution size, personal specialty, or career level. Participating in areas outside your specialty promotes the integration of ideas from multiple disciplines and can provide insight on how to apply that knowledge as we continue our work in an ever-changing and complex landscape.

In addition to the fantastic line up of sessions at this year’s Annual Meeting headquarters – the secluded Ventana Canyon Resort - attendees will have opportunities to experience the annual Poster Session, Activity Stations, Roundtable Discussions, and other social functions! Pre-Conference Tours will transpire at some of Tucson’s iconic institutions including the Tucson Botanical Gardens, the Arizona History Museum, and a combined art experience at the Center for Creative Photography, the University of Arizona Museum of Art, and the Tucson Museum of Art and Historic Block. Social gatherings continue into the night as attendees are invited to attend various Evening Events commencing with WMA’s 2024 Opening Party at the Tohono Chul botanical garden to begin our time in Tucson immersed in this enchanting environment. Further taking advantage of the restorative and rejuvenating Sonoran Desert, at our venue, nestled in the stunning foothills of Tucson’s Catalina Mountains, we have created numerous opportunities to socialize and feel a sense of BALANCE alongside our usual program filled with learning, sharing, and connecting. For the first time, WMA is hosting an Evening Event onsite at the Ventana Canyon Resort to provide attendees a lower cost and more accessible opportunity to connect after hours for social or educational activities! Additional Evening Events invite attendees to explore more of Tucson with trips to the Mini Time Machine Museum of Miniatures, the Presidio Museum, and the Tucson Museum of Art and Historic Block.

WMA’s 2024 Annual Meeting will bring together hundreds of museum professionals from across the West - and beyond - who will return home refreshed by different ideas and perspectives, nourished by new or returning connections, and with a better sense of BALANCE. We look forward to welcoming you to Tucson this September!

– **WESTERN MUSEUMS ASSOCIATION**

INVITATION	3
ACKNOWLEDGMENTS	4
SPECIAL THANKS	6
SCHEDULE AT-A-GLANCE	7
KEY INFORMATION	8
PROGRAM KEY	9
VENTANA RESORT MAP	10

WEDNESDAY, SEPTEMBER 25	12
THURSDAY, SEPTEMBER 26	16
FRIDAY, SEPTEMBER 27	25
SATURDAY, SEPTEMBER 28	32

EXHIBITORS	42
AREA INFORMATION	44
ABOUT WMA	45



ACKNOWLEDGMENTS

Thank you to the following individuals, who have all been instrumental in the planning, development, and support of this Annual Meeting. Your generous gifts of time and resources have made this Annual Meeting possible.

WMA BOARD OF DIRECTORS

Officers

PRESIDENT: Lorie Millward, *Principal, Lorie Millward Consulting*

TREASURER: Rosanna Sharpe, *Executive Director, REACH Interpretive Center*

SECRETARY: Barron Oda, *Principal, Invenio Legal Studio*

VICE PRESIDENT, MEMBERSHIP & COMMUNITY

DEVELOPMENT: Michael Fiegenschuh, *Principal, EDX Exhibits*

VICE PRESIDENT, PROGRAMS & INNOVATION:

Noelle Kahanu, *Assistant Specialist, Public Humanities and Native Hawaiian Programs, University of Hawai'i at Monoa*

IMMEDIATE PAST PRESIDENT: Dana Whitelaw, *President, High Desert Museum*

MEMBERS

Sarah Bloom, *Senior Communications Officer for Interpretation & Visitor Engagement, Bill & Melinda Gates Foundation*

Robert Caragher, *Board Member, Gamble House Conservancy*

Dan Clevenger, *DLR Group, Cultural+Performing Arts Leader | Principal*

Celina Coleman, *Director of Operations, Social Responsibility & Desert Financial Foundation, Desert Financial Credit Union*

Chloe Doucette, *Sr. Director of Programs and Engagement, Museum of Idaho*

Laurie Egan-Hedley, *Director and Curator, Barona Cultural Center and Museum*

Melanie Fales, *Executive Director, Boise Art Museum*

Jennifer Fang, *Director of Interpretation and Community Engagement, Pittock Mansion*

Gideon Gerit, *Curator of Public Art, Municipality of Anchorage. Public Art Program*

Devon Hamilton, *Learning and Experience Director, Blue Rhino Design*

Ariel Hammond, *Director of Research Library & Archives, San Diego Natural History Museum*

Lydia Heins, *Executive Director, Coos Art Museum*

Rebecca Horta, *Director of Youth & Family Programs, Los Angeles County Museum of Art*

Doug Jenzen, *Independent Museum Professional*

Johanna Jones, *Director of Evaluation and Visitor Insights, Oakland Museum of California*

Tim Lee, *Director of Exhibits, Natural History Museum of Utah*

Gail Mandel, *Deputy Director, Oregon Jewish Museum and Center for Holocaust Education*

Matt Mattice, *Executive Director, King Kamehameha V Judiciary History Center*

Kristen Mihalko, *Director of Operations, Balboa Park Cultural Partnership*

Amy Oppio, *Chief Operating Officer / Deputy Director, Nevada Museum of Art*

Carlos Ortega, *Chief Curator, Museum of Ventura County*

Natalie Petersen, *Assistant Director, Utah Division of Arts & Museums*

Bart Shively, *Chief Strategy Officer, MATT Construction*

Michelle Sifuentes, *Curator of Collections, Ontario Museum of History & Art*

Azha Simmons, *Individual Giving Manager, Sunnyvale Community Services*

Koven Smith, *Senior Director/Arts, Knight Foundation*

Niki Stewart, *VP, Chief Learning & Engagement Officer, Frank Lloyd Wright Foundation*

Hally Swift, *Assistant Director of Finance, UW Botanic Gardens and Arboretum Foundation*

Edward Tepporn, *Executive Director, Angel Island Immigration Station Foundation*

Molly Wilmoth, *Bonnie Lee and Oliver P. Steele III Curator of Education & Engagement, High Desert Museum*

Jeanette Woodburn, *Marketing Operations Manager, Iterable*

Kurosh Yahyai, *Studio Program Manager, The New Children's Museum*

SPECIAL THANKS

The WMA wishes to recognize the many colleagues who contributed their valuable time, energy, and expertise to the success of the Annual Meeting.

2024 ANNUAL MEETING HOST COMMITTEE

CO-CHAIR: Norah Diedrich, *Director & CEO, Tucson Museum of Art and Historic Block*

CO-CHAIR: William Russ, *Executive Director, Mini Time Machine Museum of Miniatures*

Diane Dittimore, *Associate Curator of Ethnological Collections, Arizona State Museum*

Vanessa Fajardo, *Exhibits Supervisor, Arizona History Museum*

Myles Gallagher, *Executive Director, Tohono O'odham Nation Cultural Center and Museum*

Amy Hartmann-Gordon, *Director, Tucson Presidio Museum*

Shirley Jackson, *Executive Director, Huhugam Heritage Center (Gila River Indian Community)*

Jennifer Juan, *Assistant Director of Community Engagement, Arizona State Museum*

Lauren Kaye, *Special Projects Manager, Children's Museum Tucson & Oro Valley*

Berlin Loa, *Assistant Professor, University of Arizona School of Information*

David Lopez, *Director of Operations, Children's Museum Tucson & Oro Valley*

Michael Muscarello, *Museum Specialist, Mini Time Machine Museum of Miniatures*

Gary Owens, Jr., *Museum Manager, Huhugam-Ki (Salt River Pima Maricopa Indian Community)*

Katie Rogerson, *Director of Education & Public Engagement, Tucson Botanical Gardens*

Myriam Sandoval, *Visitor & Member Services Lead, University of Arizona Museum of Art*

James Schaub, *Director of Education & Exhibits, Tohono Chul*

Sylvia Verbais, *Community Programs Manager, Tohono Chul*

WMA STAFF

Jason B. Jones, *Executive Director*

Jenna S. Green, *Communications Specialist*

2024 ANNUAL MEETING PROGRAM COMMITTEE

CO-CHAIR: Doug Jenzen, *Independent Museum Professional*

CO-CHAIR: Karen Kienzle, *Director, Palo Alto Art Center*

Jacqueline Cabrera, *Principal, Cabrera+Art+Management*

Eric Chang, *Arts Program Coordinator, East-West Center*

Alannah Debusk, *Collections Manager and Registrar, Sharlot Hall Museum*

Catherine Diaz, *Business Development, Exhibits, Oregon Museum of Science and Industry*

Laurie Egan-Hedley, *Director and Curator, Barona Cultural Center & Museum*

Pat Evans, *Registrar, Frank Lloyd Wright Foundation/Taliesin West*

Lisa Falk, *Head of Community Engagement and Curator of Education, Arizona State Museum*

TJ Gaudelli, *Volunteer Coordinator, Arizona Museum of Natural History*

Della Hall, *Collection Manager, University of Alaska Museum of the North*

Leslie Madsen, *Professor, Oregon State University*

Gail Mandel, *Deputy Director, Oregon Jewish Museum and Center for Holocaust Education*

Seth Margolis, *Director of Education Programs, Museum of Flight*

Nicole Meldahl, *Executive Director, Western Neighborhoods Project*

Megumi Nagata, *Heritage Lead, 4Culture*

Crystal Narcho, *Museum Specialist, Tohono O'odham Cultural Center and Museum*

Eleanor Sandys, *Principal, LOTUS Art & Museum Services*

Niki Stewart, *VP, Chief Learning & Engagement Officer, Frank Lloyd Wright Foundation*

ANNUAL MEETING SPONSORS

SCHEDULE AT A GLANCE

Thanks to all for the role you play in making this meeting so successful.



INSTITUTIONAL SUPPORT

Arizona History Museum
 Arizona State Museum
 Children's Museum Tucson & Oro Valley
 Huhugam Heritage Center (Gila River Indian Community)
 Huhugam-Ki (Salt River Pima Maricopa Indian Community)
 Mini Time Machine Museum of Miniatures
 Tohono Chul

Tohono O'odham Nation Cultural Center and Museum
 Tucson Botanical Gardens
 Tucson Museum of Art and Historic Block
 Tucson Presidio Museum
 University of Arizona Museum of Art
 University of Arizona School of Information

WEDNESDAY, SEPTEMBER 25	
9:00 AM–4:00 PM	Pre-Conference Workshops
9:00 AM–4:00 PM	Pre-Conference Tours
4:00 PM–5:00 PM	Speed Networking (Free)
5:00 PM–6:30 PM	Opening Reception (Free)
6:45 PM–9:15 PM	Evening Event: Tohono Chul
THURSDAY, SEPTEMBER 26	
8:00 AM–8:45 AM	Morning Coffee
9:00 AM–10:45 AM	Opening General Session & Keynote
11:15 AM–12:30 PM	Concurrent Sessions
12:30 PM–1:45 PM	Exhibit Hall Networking Lunch
1:45 PM–3:00 PM	Concurrent Sessions
3:00 PM–3:30 PM	Exhibit Hall Networking & Refreshment Break
3:30 PM–4:45 PM	Concurrent Sessions
5:00 PM–6:00 PM	Directors & Leadership Team Reception
5:00 PM–6:00 PM	Happy Hours
7:00 PM–9:30 PM	Evening Event: Ventana Party
FRIDAY, SEPTEMBER 27	
7:00 AM–7:45 AM	Morning Yoga
8:00 AM–8:45 AM	Morning Coffee
9:00 AM–10:15 AM	Concurrent Sessions
10:15 AM–11:00 AM	Exhibit Hall Networking & Refreshment Break
11:00 AM–12:15 PM	Concurrent Sessions
12:30 PM–1:45 PM	WMA Community Lunch
2:00 PM–3:15 PM	Concurrent Sessions
3:15 PM–4:30 PM	Exhibit Hall Closing Reception (Free)
4:30 PM–6:00 PM	Leadership Reception
6:45 PM–9:15 PM	Evening Event: Mini Time Machine Museum of Miniatures
SATURDAY, SEPTEMBER 28	
7:00 AM–7:45 AM	Morning Yoga
8:00 AM–5:00 APM	Registration Desk Open
8:00 AM–5:00 PM	Kid Zone
8:00 AM–9:00 AM	Morning Coffee
9:00 AM–10:15 AM	Concurrent Sessions
10:15 AM–10:45 AM	Coffee Break
10:45 AM–12:00 PM	Concurrent Sessions
12:15 PM–1:30 PM	Affinity Lunches
1:30 PM–3:15 PM	Inspiration Stations / Roundtables / Poster Session
3:15 PM–4:30 PM	Concurrent Sessions
4:30 PM–5:30 PM	Break
5:30 PM–9:00 PM	Evening Event: Presidio Museum / Tucson Museum of Art and Historic Block

(Please Note: Schedule and sessions are subject to change)

KEY INFORMATION



LOEWS VENTANA CANYON RESORT

2024 Annual Meeting Headquarters
7000 N Resort Drive
Tucson, AZ 85750

ANNUAL MEETING ACTIVITIES

The WMA 2024 Annual Meeting will be held at the Loews Ventana Canyon Resort

TRANSPORTATION

Scheduled buses for tours and special events will pick-up guests at the Loews Ventana Canyon Resort. Please consult the Program for shuttle times, and arrive at the pick up location fifteen minutes prior to departure. Buses will return participants to the Loews Ventana Canyon Resort.

REGISTRATION/VOLUNTEER DESK

The registration desk is located in the Grand Ballroom Foyer. The desk will be staffed during the following times:

WEDNESDAY, SEPTEMBER 25 8:00 AM–6:30 PM
THURSDAY, SEPTEMBER 26 8:00 AM–5:00 PM
FRIDAY, SEPTEMBER 27 8:00 AM–5:00 PM
SATURDAY, SEPTEMBER 28 8:00 AM–5:30 PM

EXHIBIT HALL SCHEDULE

Please visit our Exhibit Hall located in the Grand Ballroom. The Exhibit Hall will be open during the following times:

WEDNESDAY, SEPTEMBER 25 5:00 PM–6:30 PM
THURSDAY, SEPTEMBER 26 10:45 AM–5:00 PM
FRIDAY, SEPTEMBER 27 10:15 AM–4:30 PM

TICKETS

If you registered for an Evening Event or Affinity Luncheon hosted by the WMA, your tickets are located in your registration packet. Please present your ticket before boarding buses or entering an event.

GUESTS

Non-registered guests are not allowed to attend Annual Meeting sessions or workshops, but may purchase tickets to attend special social events. Please check with the Registration Desk for availability.

NAME BADGES

Name badges must be worn at all times, as only registered attendees are allowed to attend sessions and workshops.

PROGRAM CHANGES

In the event of changes to the program, an addendum will be available at the Registration Desk.

MESSAGE BOARD

Attendees may post messages, job opportunities, and exchange tickets on a message board located in the Registration area. There is no charge for this service; however, we ask that you be mindful of the limitations of space to accommodate all notes. Commercial ads are not allowed on the board, nor is material of a commercial nature allowed on tables unless arranged in advance with the WMA.

LOST & FOUND

Lost and found articles turned in at the WMA Registration Desk will be held until the end of each day, after which items will be turned over to the hotel's front desk.

PROGRAM KEY

Look for these keys throughout the program to tailor your experience!



BUSINESS & ADMINISTRATION

Do any of these sound like a day in your life: marketing, writing a grant proposal, managing digital assets, setting up a business plan, social media, working within a budget, pitching a proposal, or figuring out an ad campaign? If so, come hear colleagues in development, finance, and marketing share best practices.



COLLECTIONS

Calling all registrars, conservators, collection managers, curators, and art handlers! These sessions and workshops focus on what you need to know to safeguard your museum's collections now and for years to come.



COMMUNITY ENGAGEMENT

Engaging your museum's community is essential for remaining relevant, offering new and meaningful experiences, and reaching wider audiences. These sessions provide insight into the process of developing community partnerships, community-based initiatives, and enhancing your mission through outreach.



INDIGENOUS

These sessions provide a platform for indigenous and non-indigenous museum staff to explore issues from diverse perspectives, to learn about innovative projects, and to deepen practice-transforming sensitivities.



LEADERSHIP & CAREERPATH

For anyone in the museum field wanting to explore issues related to professional development, institutional governance, unraveling roles and responsibilities, management of human resources, developing leadership capacity, and getting ahead in your career.



VISITOR EXPERIENCE

Educators, designers, curators, evaluators, administrators, and visitors all have their own perspective on the museum-going experience. Hear some great case studies of recent past work and start charting the future of your museum's experience!



TRUSTEE

These sessions, developed by the Museum Trustee Association, offer museum trustees the opportunity to learn from and network with other museum leaders



ARIZONA

These sessions, developed by the Museum Association of Arizona, offer insight to museum work in our host state

Connect with WMA!

Use #wma2024

Post pictures on our Facebook Wall @westmuse

Tweet us @westmuse

Tag us on Instagram @westmuse.pics



VENTANA RESORT MAP

The WMA Annual Meeting Registration Desk can be found in the Grand Ballroom Foyer, and all activities take place in various meeting spaces.

Loews Ventana Canyon Resort

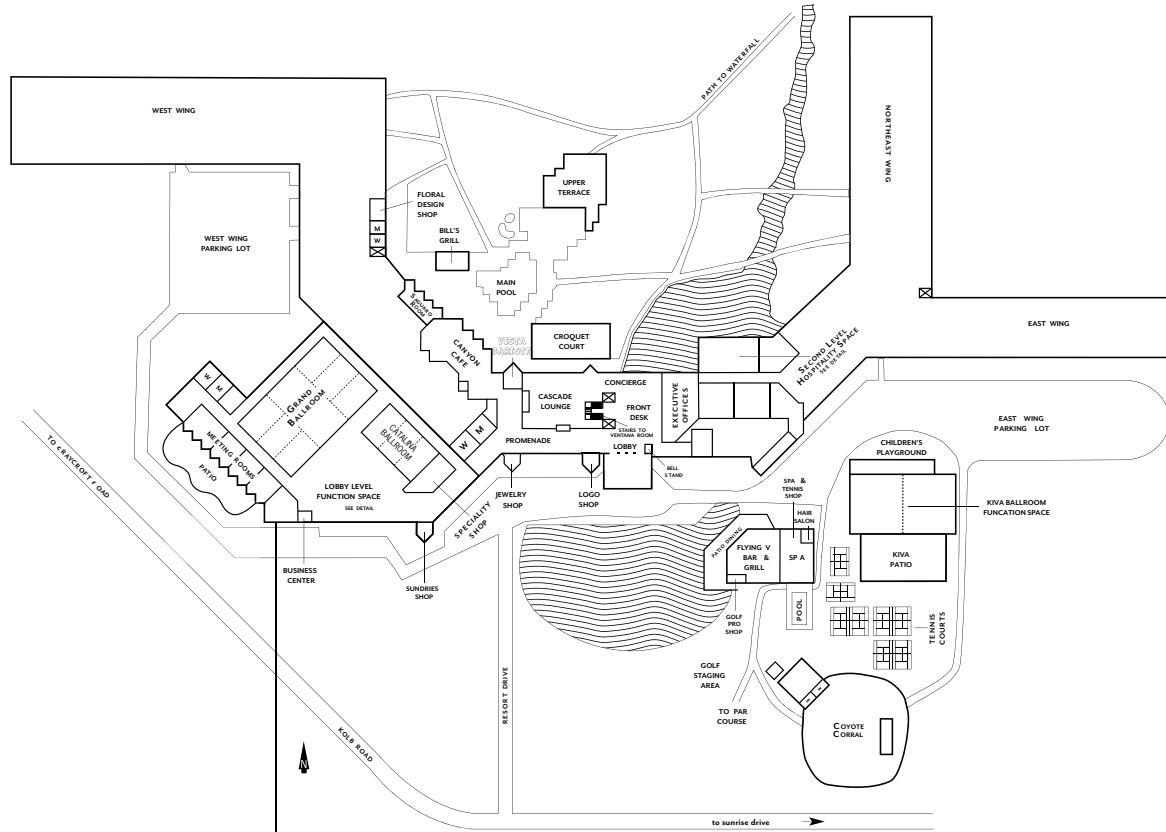

Enhanced View

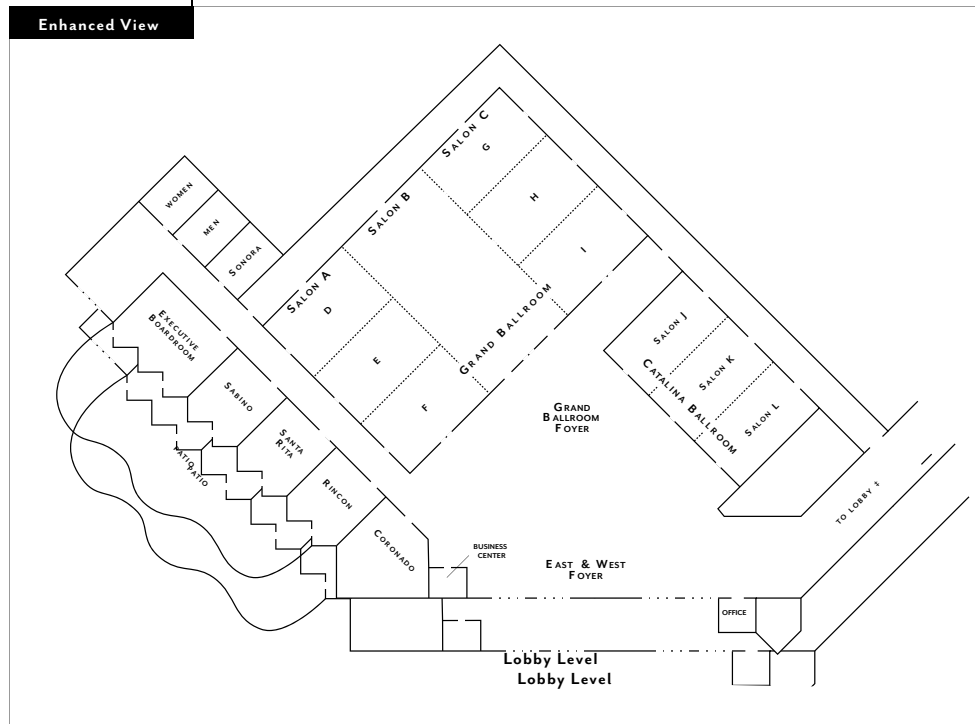

When your "Endeavour" MATTERS

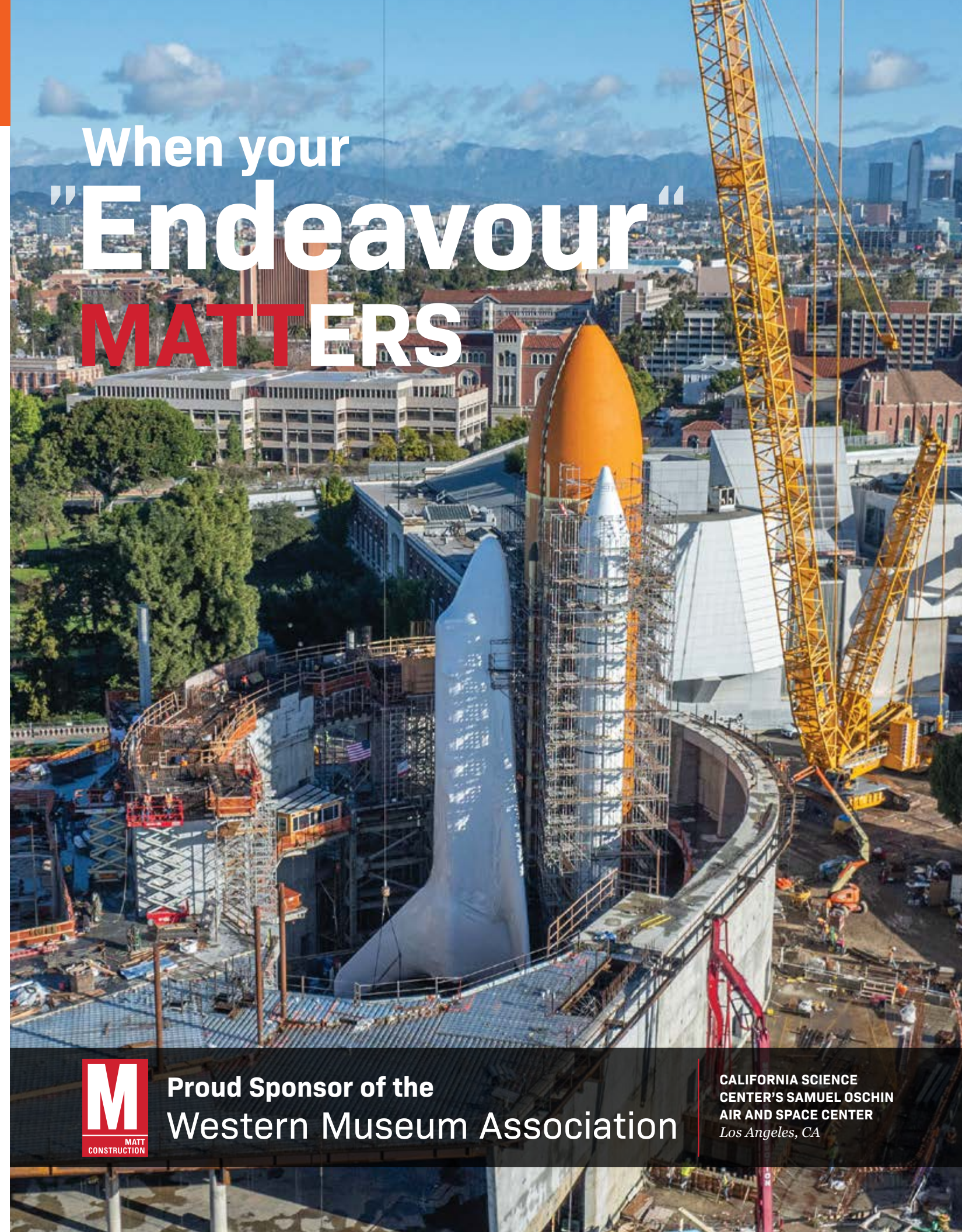

Proud Sponsor of the
Western Museum Association

CALIFORNIA SCIENCE
CENTER'S SAMUEL OSCHIN
AIR AND SPACE CENTER
Los Angeles, CA

PRE-CONFERENCE TOURS

Pre-Conference Tours are not included in the Annual Meeting registration fee and required pre-registration. Buses will pick up attendees in front of the Ventana Canyon Resort. Please arrive 15 minutes prior to the below scheduled departures.

9:00 AM–12:00 PM

TUCSON BOTANICAL GARDENS

\$70, includes transportation and a guided tour

Located on the site of the historic Porter property, Tucson Botanical Gardens (TBG) is a five and a half acre collection of 20 gardens in the heart of Tucson, Arizona. A true urban oasis, Tucson Botanical Gardens was selected #4 in USA Today’s 10 Best Botanical Gardens Readers’ Choice Awards, 2 years in a row. 20 curated gardens including a world class Cactus & Succulent Garden, Barrio Garden, Children’s Garden, Herb Garden, and many more, showcase a diversity of plants both native and those you wouldn’t expect to see in the Sonoran Desert. Attendees will start with a docent led tour with some free choice wandering afterwards.



9:00 AM–12:30 PM

ARIZONA HISTORY MUSEUM

\$70, includes transportation and a guided tour

Join us at the Arizona History Museum for a guided tour! The Arizona History Museum is home to 30,000 collections pieces, and our Library and Archives is over 19,000 square feet and holds 1500 manuscript collections and over 1 million individual images. After a tour of the galleries, you will spend time with our collections staff and get a closer look at some of our most interesting pieces not on display, and then head on over to our Library and Archives to explore and learn about Arizona’s past from those who know it best!



9:00 AM–3:00 PM

UNIVERSITY OF ARIZONA MUSEUM OF ART / TUCSON MUSEUM OF ART AND HISTORIC BLOCK

\$80, includes transportation and a guided tours, lunch at the TMAHB café is pay your way

Enjoy a day of art in Tucson at the University of Arizona Museum of Art and the Tucson Museum of Art and Historic Block. The tour will start at the UAMA where attendees will dive into the story of Woman-Ochre painted by Willem de Kooning which was brazenly stolen from the museum, recovered after 32 years, and recently restored. Then head to the Tucson Museum of Art and Historic Block for lunch at the museum’s café (pay your own way) and a tour of current exhibitions.



PRE-CONFERENCE WORKSHOPS

Pre-Conference Workshops are not included in the Annual Meeting registration fee and required pre-registration. All workshops will be held at the Ventana Canyon Resort.

9:00 AM – 1:00 PM

ADVENTURES IN MUSEUM ARCHIVES

\$25, includes all materials

While most museums hold important archival materials, those responsible for these collections, especially in small and mid-sized museums, may not have access to “museum-friendly” training for their organization, care and access. This workshop, led by professional archivists who have experience working with museums, will provide introductions to key areas of archival practice as they pertain to museum collections, through a series of brief presentations, informal Q-and-A, hands-on activities, and resource materials.

PRESENTERS: Melissa Lawton, *Archivist for Collections Management, Northern Arizona University*
Shannon Walker, *University Archivist, Arizona State University*
Berlin Loa, *Assistant Professor, iSchool, University of Arizona*
David Barnard, *Archives and Special Collections Assistant, James E Rogers College of Law, University of Arizona*

9:00 AM – 1:00 PM

SEVEN CORE MANAGEMENT SKILLS FOR MUSEUM FOLKS

\$25, includes all materials

Are you an early museum professional who wants to prepare themselves for future roles and responsibilities? Or maybe you are a new manager feeling overwhelmed by the mountain of skills and experiences that you think you need to be an expert at? This half day workshop will provide an introduction to 7 core management skills to help you identify your superhero skills (strengths) and your kryptonite (growth edges).

PRESENTER: Edward Tepporn, *Executive Director, Angel Island Immigration Station Foundation*

9:00 AM – 1:00 PM

HARNESS THE TECHNIQUES OF AUGMENTED REALITY (AR)

\$35, includes all materials

Mystified by what is Augmented Reality (AR) and how to use it at your institution? Join us to learn how to harness the techniques of AR to bring your exhibits to life! During the workshop you will scan objects to make 3D files, learn about equipment and editing files, become familiar with basics of hologram creation, learn to create QR codes or triggers for starting the AR experience, consider signage design, and discuss planning your own AR projects.

PRESENTERS: Lisa Falk, *Head of Community Engagement, Arizona State Museum*
Bryan Carter, *Director of the Center for Digital Humanities and Professor of Africana Studies, College of Humanities at University of Arizona*
Max Mijjn, *Digital Asset Specialist, Arizona State Museum*



WMA BOARD MEETING INVITATION ONLY
10:00 AM – 11:00 AM New Board Member Orientation
11:00 AM - 4:00 PM Board Meeting

Location: TBD

2:00 PM - 4:00 PM
STATE ASSOCIATION EXCHANGE INVITATION ONLY
FREE!

Location: TBD

4:00 PM–5:00 PM
SPEED NETWORKING
FREE!

Location: Grand Ballroom Foyer

Kick off your conference experience with a lively hour of Speed Networking! Bring plenty of business cards, your sense of humor, and comfortable shoes. Everyone is encouraged to join us for a friendly, timed-interval business card exchange social hour. This people-rotating format encourages brief individual introductions between everyone in the room. Want to keep the conversation going? Following the structured program, we will save time for mingling before continuing on to the Opening Reception.

5:00 PM–6:30 PM

OPENING RECEPTION

Location: Grand Ballroom

Join your fellow Annual Meeting attendees for an Opening Reception in the Exhibit Hall. Spend your first evening in Tucson enjoying appetizers, drinks, and conversing with colleagues and our corporate members.

*Event Sponsored by SmithGroup,
Wine Sponsored by Sedona Heritage Museum*

EVENING EVENT

6:45 PM–9:15 PM

TOHONO CHUL

\$60 per ticket, *includes beverages, hearty appetizers, and dessert*

Be welcomed to Tucson at Tohono Chul, a 49-acre Sonoran Desert Oasis, and a charming crossroads of nature, art, and culture. The vibrant offerings at Tohono Chul will awaken your senses. Stroll along winding paths past soaring Saguaros, through themed botanical gardens, and marvel at a chance encounter with a resident hummingbird. Enjoy a quiet retreat in the artfully designed relaxation spots sprinkled throughout the grounds. Various art and garden exhibits reveal the unique qualities of the Sonoran region and renew a deep appreciation for the treasures of the desert. Docents and volunteers will be on-hand to enhance the experience and guide attendees through this desert paradise.

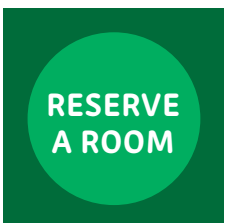



MORNING COFFEE FREE!

Join your fellow Annual Meeting attendees for coffee, while connecting with new colleagues and seeing familiar faces.

Sponsored by USF Museum Studies Program

Location: Kiva Ballroom

9:00 AM–10:45 AM

OPENING GENERAL SESSION & KEYNOTE

Join us as we welcome attendees to Tucson, present the 2024 Awards – the Charles Redd Center Award for Exhibition Excellence, the WMA Leadership Award, and the Arthur H. Wolf Impact Award—and get inspired by the 2024 keynote speaker!

OPENING REMARKS

Jason B. Jones, *Executive Director, Western Museums Association*

LOCAL WELCOME TBD

WMA PRESIDENT’S ADDRESS

Lorie Millward, *Principal, Lorie Millward Consulting*

AWARDS PRESENTATION

Noelle Kahanu, *Assistant Specialist, Public Humanities and Native Hawaiian Programs, University of Hawai’i at Monoa*

KEYNOTE ADDRESS

Seema Rao,
Principal, Brilliant Idea Studio

Sponsored by MATT Construction

Location: Grand Ballroom Foyer



CONCURRENT SESSIONS 11:15 AM–12:30 PM

A1 WMA2024_423

**SUSTAINABLE MUSEUM LEADERSHIP:
CULTIVATING WELL-BEING FROM THE INSIDE-OUT**

LEARNING FORMAT: CONVERSATION



Museum leaders have so many different kinds of people they must take care of that they often forget to take care of themselves. Putting on our own oxygen masks first can feel counter-intuitive, but it’s a cornerstone of sustainable leadership. It also models to others what well-being can look like. Join us for an honest conversation about our struggles, strategies, practices, and – on a good day – triumphs as we try our best to keep sane in the insane world of museum leadership today.

MODERATOR: Micah Parzen, *CEO, Museum of Us*

PRESENTERS: Leticia Gomez-Franco, *Executive Director, Balboa Arts Conservation Center (BACC)*

Joel Barraquiel Tan, *Executive Director, Wing Luke Museum*

A2 WMA2024_398

THE STORIES WE TELL IN EXHIBITS: NATIVE CURATION AND TRUTH-TELLING

LEARNING FORMAT: PASSIVE LEARNING



While developing a community collaborative exhibit at the Arizona State Museum, Tohono O’odham community curators were drawn to storytelling as a way of recognizing identity. Initial conversations kept returning to truth-telling and the stories we tell ourselves as Native individuals, and members of a larger community. This led us to continuously ask, “but is that real?” This session will share the process of developing an exhibit for a mostly non-native audience, while focusing on our truths.

MODERATOR: Jennifer Juan, *Assistant Director of Community Engagement, Arizona State Museum*

PRESENTERS: April Ignacio, *Community Curator, Arizona State Museum*

Dedric Lupe, *Curator of Collections, Tohono O’odham Nation Cultural Center & Museum*

Tony Burrell, *Community Curator, Arizona State Museum*

A3 WMA2024_NEW1

SHIPPING ART & ARTIFACTS 101

LEARNING FORMAT: PASSIVE LEARNING



Join your registrar and collection colleagues on learning about how to ship objects from your collection to and from another cultural institution or incoming loans for your exhibitions. This session will cover basic how to, terminology, resources, and provide templates for your use. Airfreight (international and domestic) and trucking shipment options will be covered.

MODERATOR: Jacqueline Cabrera, *Principal, Cabrera Art Management LLC*

PRESENTERS:

Katy Hess, *Senior Registrar of Collections and Exhibitions, Bowers Museum*

Amanda Schumante, *Manager, West Coast Exhibitions*

A4 WMA2024_355
AUTHENTIC AND EQUITABLE COMMUNITY ENGAGEMENT AND FOUNDATIONAL RELATIONSHIP BUILDING

LEARNING FORMAT: CONVERSATION



This session focuses on recognizing the important role Museums play regarding community engagement and representation. Attendees will evaluate their experiences with engaging and supporting community and learn new methods for approaching, engaging, and working with the community to build new relationships. The session will be presented as a conversation between moderator, presenter, and attendees and serve as an example of one possible forum of community gathering session.

MODERATOR: Elvira Suarez Din, *Director of Community Engagement, Supervisor Adelita S. Grijalva, Chair for the Pima County Board of Supervisors*

PRESENTERS: Rikki Riojas, *Executive Director, Los Descendientes De Tucson/ Mexican American Museum*
Alisha Vasquez, *Community Director, Mexican American Museum*
Bianca Finley Alper, *Special Collections Archivist, The University of Arizona*

A5 WMA2024_356
CULTURAL PLANNING AND MUSEUMS: CULTURAL ECOSYSTEMS AND COMMUNITY IMPACT

LEARNING FORMAT: CONVERSATION



Cultural planning provides a process for collaborating across sectors and ensuring that museums better meet community needs and deepen their community impact by identifying high-level priorities. This session will focus on how cultural plans benefit from museums as leaders in the planning process, how museums benefit from participating in cultural plans, and how planning across institutions deepens impact for all museums in an ecosystem.

MODERATOR: Norah Diedrich, *Jon & Linda Ender Director / CEO, Tucson Museum of Art*

PRESENTERS: Holly Shen, *Director, US, Lord Cultural Resources*
Lane Mandle, *Chief of Staff, City Manager's Office*
Rikki Rojas, *Executive Director, Los Descendientes De Tucson*

12:30 PM-1:45 PM

EXHIBIT HALL NETWORKING LUNCH

Location: Grand Ballroom

FREE!

Join your colleagues in the Exhibit Hall where you can explore vendor offerings and enjoy lunch courtesy of the WMA. Make sure to start bidding on the fabulous items in the silent auction that were generously donated by our members. All proceeds benefit the Wanda Chin Scholarship funds to help colleagues attend future Annual Meetings.

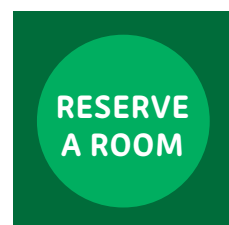

CONCURRENT SESSIONS 11:15 AM-12:30 PM

B1 WMA2024_389
CREATING RESPONSIVE PROGRAMS: EVENTS BASED ON VISITOR BEHAVIOR

LEARNING FORMAT: ACTIVE LEARNING



Learn how to create a responsive program - a term to describe events created in response to visitor needs and behaviors. Rather than solely creating programs born from the museum's initiatives, responsive programs - whether about wellness, activism, or access - center visitor engagement. Attendees will participate in a short responsive program, hear examples from SAM, LACMA, and The Huntington, then engage in a workshop to create a responsive program for their organizations.

PRESENTERS: Elizabeth (Elee) Wood, *Nadine and Robert A. Skotheim Director of Education and Public Programs, The Huntington*
Elizabeth Gerber, *Senior Educator, Programs and Engagement, Los Angeles County Museum of Art (LACMA)*

B2 WMA2024_364
BALANCING IDEA

LEARNING FORMAT: CONVERSATION

Intentional choices must be made to balance priorities and resources related to the broad work of IDEA (Inclusion, Diversity, Equity, Accessibility). Boise Art Museum will share a case study, with touchable and tangible samples, of their four-year journey to assess its practices and to create new interpretive initiatives and affordances to increase access and inclusion, in an effort to welcome people who are blind, deaf, or neuro-diverse.

MODERATOR: Melanie Fales, *Executive Director, Boise Art Museum*

PRESENTERS: Tara Adams, *Deaf Talent of BAM-produced ASL videos (ASL interpreter and Deaf community member)*
Robin Marquis, *Senior Inclusion Strategist, Prime Access Consulting*

B3 WMA2024_346
LEADING IN 360-DEGREES: MANAGING UP, DOWN, AND SIDEWAYS

LEARNING FORMAT: CONVERSATION



Do you ever find yourself having to lead people who don't directly report to you? Us too. Join this group of museum professionals to engage in conversation about managing and leading in multiple directions with professionalism, humor, and grace. The session will start with a discussion between the panelists, and then move into small group conversations with all participants. It will conclude by reconvening and sharing what we heard, offering best practices for all.

PRESENTERS: Niki Stewart, *VP, Chief Learning & Engagement Officer, Frank Lloyd Wright Foundation*
Gail Mandel, *Chief Operating and Advancement Officer, Oregon Jewish Museum and Center for Holocaust Education*
Edward Tepporn, *Executive Director, Angel Island Immigration Station Foundation*
Devon Hamilton, *Learning and Experience Director, Blue Rhino Design*



B4 WMA2024_374
INNOVATION IN COMMUNITY COLLABORATION AND ENGAGEMENT USING AUGMENTED REALITY

LEARNING FORMAT: ACTIVE LEARNING



University, museum, and community partners will share how this cohort of learners created geographically dispersed Augmented Reality (AR) experiences around the theme of community in the Borderlands. Discover what AR is, the diverse skills required to create these types of projects, the challenges of using new technology, and how to develop linked content. Hear community partners share what the collaborative meant to them. Attendees will try the Discovering Community in the Borderlands AR experiences.

MODERATOR: Lisa Falk, Head, *Community Engagement/Curator of Education, Arizona State Museum*
PRESENTERS: Dr. Bryan Carter, *Director, Center for Digital Humanities / Professor, Africana Studies, College of Humanities (One or two of the students at CDH may also join us for the session.), University of Arizona*
 Robin Blackwood, *History Programs volunteer, Tucson Chinese Cultural Center*
 Barbara Lewis, *Director, Dunbar Pavilion*
 Max Mij, *Digital Asset Specialist, Arizona State Museum*

B5 WMA2024_424
THE FUTURE OF INDIGENOUS EXHIBITIONS IN A POST-NAGPRA WORLD

LEARNING FORMAT: PASSIVE LEARNING



In January of 2024, regulatory changes to Native American Graves Protection and Repatriation Act (NAGPRA) went into effect introducing a new definition of “duty of care.” The expanded language mandates that museums must “obtain free, prior, and informed consent from lineal descendants, Indian Tribes, or Native Hawaiian organizations prior to allowing any exhibition of, access to, or research on human remains or cultural items.” Museums have responded by removing collections from display, closing exhibition areas and even entire halls. This panel will invite those knowledgeable in the field to discuss the statute, regulatory changes, and implications for the field and museum and indigenous community relations.

MODERATOR: Noelle Kahanu, *Assistant Specialist, Public Humanities and Native Hawaiian Programs, University of Hawaii at Manoa*
PRESENTERS: Barron Oda, *Principal, Invenio Legal Studio LLLC*
 Angela Neller, *Curator, Wanapum Heritage Center*
 TBD

3:00 PM–3:30 PM

EXHIBIT HALL NETWORKING & REFRESHMENT BREAK Location: Grand Ballroom

Enjoy coffee, tea, and light snacks while perusing exhibitors’ booths, bidding on silent auction items, and networking with peers.

Sponsored by Utah Division of Arts & Museums



CONCURRENT SESSIONS 3:30 PM–4:45 PM

C1 WMA2024_387
COMMITMENT OF ACTION: TRIBAL SOVEREIGNTY AND MUNICIPAL MUSEUMS

LEARNING FORMAT: CONVERSATION



Municipal Museums have a unique relationship when working with Tribal consultation. As Museum professionals, we play the role of envoys from our Council and City Management and Tribal representatives are envoys for their Council and Tribal Management. As such, we are formally negotiating between two world views and two sovereign Nations. We will use recent examples of consultation regarding the role museums play, including name changes, the development of programming, exhibits, and more.

MODERATOR: Simon Tipene Adlam, *Museum Administrator, Arizona Museum of Natural History*
PRESENTERS: Nicole Armstrong-Best, *Museum Administrator, S’edav Va’aki Museum*
 Reyllyne Williams, *Cultural Resource Specialist, Tribal Historic Preservation Office/GRIC*

C2 WMA2024_381
WE BUILT A BAR IN THE MIDDLE OF THE GALLERY.

LEARNING FORMAT: ACTIVE LEARNING



This session explores the dynamic relationship between education and curation by advocating for the incorporation of dedicated educational spaces within gallery settings. This session is inspired by the current exhibition at the Discovery Center where we built a ‘Water Bar’ inside of the exhibition, the bartenders are education staff, staging water tastings, pop-up activities and activations throughout the run of the exhibition. The session will explore innovative strategies the Discovery Center and other museum spaces have taken in incorporating permanent education spaces in gallery spaces, and practical examples of how galleries can serve as hubs for both appreciation and learning. The presenters will share key lessons learned, visitor feedback, and learning outcomes throughout the session.

MODERATOR: Sarah Bloom, *Head of Exhibitions and Interpretation, Gates Foundation*
PRESENTERS: Patrick McMahon, *Head of Operations and Visitor Services, Gates Foundation Discovery Center*

C3 WMA2024_394
FINDING BELONGING AND BALANCE THROUGH ART MUSEUM VISITS

LEARNING FORMAT: ACTIVE LEARNING



How might care theory and praxis cultivate a sense of belonging between university students and museums? What does care theory and praxis look like currently in university art museums? This session will explore how one art museum became a site for cultivating care and belonging through two different approaches to audience engagement. Participants are invited to reflect on the role of museums and museum education while practicing acts of care.

PRESENTERS: Chelsea Farrar, *Curator of Community Engagement, University of Arizona Museum of Art*
 Jenna S. Green, *PhD student in Art & Visual Culture Education, University of Arizona*
 Carissa DiCindio, *Associate Professor, Art and Visual Culture Education, Co-Director, Museum Studies Graduate Certificate, University of Arizona*
 Linda Garcia Escobar, *Undergraduate student in Art & Visual Culture Education; University of Arizona Museum of Art Intern, University of Arizona*

C4 WMA2024_393

BALANCING GOALS AND GROWTH BETWEEN MUSEUMS AND CORPORATE PARTNERS

LEARNING FORMAT: CONVERSATION



Do you wonder what corporations are looking for when partnering with museums? Have you filled out countless sponsorship request forms without success? Join us for a panel discussion with museum development and philanthropic giving professionals to learn what makes for successful partnerships and tips for establishing (or maintaining) one at your institution.

MODERATOR: Celina Coleman, Director of Operations, Social Responsibility, Desert Financial Credit Union

PRESENTERS: Savannah Heath, Community & Government Relations Coordinator, Sundt Construction

Julie Winslett, Independent Consultant, Formerly Desert Botanical Garden and Arizona Science Center

Stella O'Rourke, Director of Philanthropy and Special Events, Arizona Coyotes

TBD

C5 WMA2024_386

COLLECTIONS POLICY: WHAT IS IT GOOD FOR?

LEARNING FORMAT: ACTIVE LEARNING



This workshop will walk participants through John Simmons's "Things Great and Small" and help them develop and think about what needs to be included in their own Collections Policy. Participants should be able to leave with an outline of a Collections Policy.

PRESENTERS: Melanie Deer, Collections Manager and Assistant NAGPRA Coordinator of Cultural Items, Center for Archaeology and Society Repository

5:00 PM-6:00 PM

DIRECTORS, TRUSTEES, & LEADERSHIP TEAM RECEPTION

Location: TBD

\$40 per ticket

Join your fellow directors, trustees, and leadership team members in this special reception.

Sponsored by DLR Group

5:00 PM-6:00 PM

HAPPY HOURS

Location: Kiva Ballroom Courtyard

\$15 per ticket, includes one drink

WMA's Happy Hours are casual events for attendees to meet and socialize. Non-alcoholic beverages will be free, and your ticket will get you one alcoholic drink with cash bar available.

EXHIBITS: DRINK AND DRAW

Get to know colleagues working on exhibitions from around the region over drinks. Re-energize and engage with your peers in this playful happy hour. Participants should bring their creative spirit and be prepared to have fun while making new connections. The goal is to gather people interested in, or working on, creating museum exhibitions. Along with socializing, we'll talk about collaborative design processes and conduct fun activities for developing ideas around random exhibition topics. Paper, drawing instruments (pens, pencils, markers, etc.), as well as some prizes will be provided.

Sponsored by EOS Lightmedia

COLLECTION HAPPY HOUR

Get to know colleagues working in collections from around the region over drinks. Registrars Committee Western Region has organized this happy hour to give attendees the opportunity to discuss a variety of collections care and registration topics with other attendees, including but not limited to: policies and procedures, emergency preparedness and response, and ethical concerns.

SMALL MUSEUMS

Get to know colleagues working in small museums from around the region over drinks. In addition to providing an opportunity for attendees from small museums to get together in a relaxed setting, we will also discuss the possibility of creating a Western Region small museum group that could function as a special interest group (like the Registrars), creating programs, conference session proposals, and other activities.

BUSINESS CARD BINGO

Hoping to meet some new people at this year's WMA Annual Meeting? Join us to play Business Card BINGO! At this happy hour session, grab a BINGO card and start moving around the room. As you meet new people, ask them some questions from your BINGO card. When you find a match, attach their business card to that space. We'll supply the BINGO cards, the adhesive, and even some blank cards - just in case you don't have any yourself.

PING PONG PATHWAYS! SHARE AND LEARN

Come for the tabletop games, stay for the stories! Like a game of ping pong, many museum professionals bounce between sometimes odd or indirect pathways to get to where they are going. Hang out, share your own odd jobs stories, or learn about others' journeys. We will learn with and from each other on how to identify and communicate your unique transferrable skills, and what could take you to the next level. Open to all museum professionals - reminisce or get inspired!



THURSDAY, SEPTEMBER 26



6:00–7:00 PM

DINNER ON YOUR OWN

Before tonight’s Evening Event, take the time to enjoy a dinner on your own, or with fellow WMA friends.

EVENING EVENT

7:00–9:30 PM

VENTANA CANYON RESORT

\$40 per ticket, includes beverages and hearty appetizers

Kick back with WMA at Ventana Canyon Resort! After the first full conference day, find your BALANCE by taking it easy with libations, hearty appetizers, and an exciting mix of activities and educational offerings to connect with fellow attendees. Find space to unwind with a short film series highlighting the amazing work of our colleagues at the Anchorage Museum and the Burke Museum. Learn about Kumeyaay culture through playing traditional games. Attend the session “Championing New Pride Programming” and dream up your own drag number. Through it all, forge new connections, find old friends, and recharge—with no need to rush to catch that last event shuttle.



FRIDAY, SEPTEMBER 27



8:00 AM–8:45 AM

MORNING COFFEE

FREE!

Join your fellow Annual Meeting attendees for coffee, while connecting with new colleagues and seeing familiar faces

Location: Grand Ballroom Foyer

CONCURRENT SESSIONS 9:00 AM–10:15 AM

D1 WMA2024_MTA#1

**FORGING NEW PATHWAYS: TRUSTEES OF COLOR
ADVANCING EQUITY IN THE CULTURAL SECTOR**

LEARNING FORMAT: CONVERSATION



As museums and cultural institutions strive to better understand what it means for an organization to center equity, diversity and inclusion, an influential group of trustees who identify as people of color and who serve on the boards of the Denver Metro area’s largest arts and culture organizations, are working together toward a shared goal: the advancement of diversity, inclusion, equity, and accessibility within arts and culture organizations. Two board members from the Denver area will reflect on their roles as advocates for increased access, representation, and inclusion in the arts and offer their insights into leading transformational change.

MODERATOR: Name, Title, Org (if one, if not omit moderator section)

PRESENTERS: TBD

D2 WMA2024_418

ART OF MEMORY: ENGAGING VISITORS WITH DEMENTIA

LEARNING FORMAT: PASSIVE LEARNING



Since 2007, the Tucson Museum of Art has partners with the Alzheimer’s Association Desert Southwest Chapter to provide a program for people with dementia and their caregiver. In this session, learn about how the program is designed, how staff and volunteers are trained, and what successes and failure the program has had. Hear from both the museum as well as the Alzheimer Association to understand the benefit of a program like this.

PRESENTERS: Morgen Hartford, *Southern Arizona Community Executive, Alzheimer’s Association Desert Southwest Chapter*
Nick Castor, *Lead Teacher/ Education Coordinator, Tucson Museum of Art*
Morgan Wells, *Director of Education, Tucson Museum of Art*

D3 WMA2024_363

COMING TOGETHER IN UNITY – BAITHAJ HARVEST 2023

LEARNING FORMAT: PASSIVE LEARNING



Indigenous museums are entrusted with an important role within their communities which is the continuation and revitalization of lifeways. The Huhugam Ki: Museum and Huhugam Heritage Center partnered together to hold their first Baithaj (Saguaro fruit) harvest in the summer of 2023. The presenters will share how two indigenous museums are collaborating to ensure that harvesting of native foods continues into the future.

PRESENTERS: Shirley Jackson, *Director, Huhugam Heritage Center, Gila River Indian Community*
Gary Owens, *Manager/Director, Huhugam Ki: Museum, Salt River Pima-Maricopa Indian Community*

D4 WMA2024_391
BALANCING THE COMMUNITY'S DESIRES AND MUSEUM'S RESOURCES...IS IT POSSIBLE?



LEARNING FORMAT: CONVERSATION

Get ready for lively conversation about everything we come across when attempting to balance the demands and desires of outside stakeholders with our museum's capacity. Whether it's a city's censorship of your exhibit or an outside collaborator who has no clue they need to abide deadlines...let's share and learn from others who live to tell the tale! Spoiler: we'll be modeling Edward de Bono's "Six Thinking Hats"--a simple and effect (and fun!) thinking process.

PRESENTERS: Kristine Clark, *Community Engagement Specialist, Chandler Museum*
 Nate Meyers, *Executive Director, Sedona Heritage Museum*

D5 WMA2024_377
IN CASE OF EMERGENCY: FUTURE-PROOFING YOUR COLLECTIONS WITH EMERGENCY PLANNING



LEARNING FORMAT: CONVERSATION

Whether your museum is proactively planning for a crisis or faces imminent danger, emergency planning is essential for collecting organizations. Focused on disaster planning, risk assessment, and implementation of emergency preparedness measures, attendees will learn emergency preparedness essentials, listen to real-life case studies, and work through problem-solving activities. This session, led by the board members of the Registrars Committee-Western Region (RC-WR), equips museum professionals with knowledge and strategies to safeguard collections from disasters.

MODERATOR: Lydia Heins, *Executive Director, Coos Art Museum*
PRESENTERS: Melanie Deer, *Collections Manager/Assistant NAGPRA Coordinator for Cultural Items, School of Human Evolution and Social Change at Arizona State University*
 Melanie Tran, *Chief Curator, California State Railroad Museum*
 Stephanie Mohr, *Collections Manager, Eastside Heritage Center*

10:15 AM–11:00 AM

EXHIBIT HALL NETWORKING & REFRESHMENT BREAK

Location: Grand Ballroom Foyer

FREE!
 Enjoy coffee, tea, and light snacks while perusing exhibitors' booths, bidding on silent auction items, and networking with peers.

Sponsored by CCS Fundraising

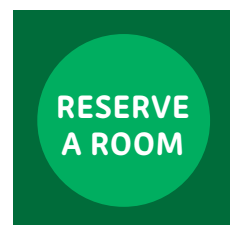

CONCURRENT SESSIONS 11:00 AM–12:15 PM

E1 WMA2024_414
THE COMPLEX JOURNEY OF DECOLONIZING COLONIAL INSTITUTIONS



LEARNING FORMAT: CONVERSATION

Join a conversation with three unique organizations who are on a path of decolonization – from policies, programs, collections management, historical designations, to name changes – The Museum of Us, Burke Museum and The Confluence (formerly Fort Calgary) will discuss their paths to truth and reconciliation.

MODERATOR: Polly Olsen (Yakama), *"Director of Diversity, Equity, Access, Inclusion & Decolonization / Tribal Liaison, Burke Museum*

PRESENTERS: Jennifer Thompson, *President, Fort Calgary (today) – The Confluence Historic Site & Parkland (as of May 2)*
 Jesi Bennet, *Director of Decolonizing Initiatives, Museum of Us*
 Aaron McCanna, *Decolonization Manager, Burke Museum*

E2 WMA2024_366
HONORING VISITOR CONTRIBUTIONS: TOOLS FOR ANALYZING TALKBACK EXHIBIT DATA



LEARNING FORMAT: ACTIVE LEARNING

Talkback exhibits prompt visitors to respond on Post-it Notes, notebooks, or digital platforms, bringing their perspectives and voices into exhibitions. Such exhibits have become commonplace in museums, but few are treating the responses as data sources and mining them for insights into visitor engagement, meaning-making, and dialogue. In this session, presenters will discuss case studies and provide frameworks for analyzing different types of talkback data. Attendees will share their talkback data and develop analysis plans.

MODERATOR: Johanna Jones, *Director, Evaluation and Visitor Insights, Oakland Museum of California*
PRESENTERS: Leslie Dueñas, *Visitor Insights Specialist, Oakland Museum of California*
 Mercedes Bertero, *Graduate Student, University of Washington*

E3 WMA2024_MTA#2
MANAGING COLLECTION INSURANCE



LEARNING FORMAT: PASSIVE LEARNING

The effect of climate change has impacted property. There has been an increase in claims activity, which has repercussions on the fine art collector and museum collection in the form of increased insurance premiums. This session will provide an overview of global fine art loss, offer insights into collection management and how emergency planning can form mitigation techniques that will enhance the protection of your collection. Included in this discussion on weather-related risk factors, you will learn basic concepts in risk management, standard operating procedures, disaster, and evacuation planning, and how to determine probable maximum loss so that your collection is properly insured to protect against catastrophic events.

MODERATOR: Name, Title, Org (if one, if not omit moderator section)
PRESENTERS: TBD



E4 WMA2024_358
EXPANDING NARRATIVES AND REPRESENTATION THROUGH COMMUNITY-BASED CURATION



LEARNING FORMAT: ACTIVE LEARNING

This session will explore innovations, impacts, and strategies for fostering collaborative and community-based curation. Presenters, comprised of community collaborators and museum professionals, will share a case study from the Tucson Museum of Art that offers a framework, tools, and questions for consideration when co-creating interpretative content. To illustrate community-curation practices, attendees will workshop a selection of artworks and themes from art of the American West to explore a 21st century vision of cultures and ideas.

MODERATOR: Marianna Pegna, *Director of Engagement and Inclusion, Tucson Museum of Art and Historic Block*
PRESENTERS: Christine Brindza, *Senior Curator, Glasser Curator of Art of the American West, Tucson Museum of Art and Historic Block*
 Elizabeth Denneau, *Artist/Educator*
 Feng-Feng Yeh, *Artist/Chef*

E5 WMA2024_361
IS IT YOUR TIME FOR CHANGE?



LEARNING FORMAT: CONVERSATION

Do you find yourself in a position that has lost its luster, become slightly unfulfilling, or overwhelming? It may not be an awful job, but is it stretching your mind and heart? Do you love the institution but just have the wrong job, or do you dislike the place but love the job? How do you evaluate your circumstance and make a plan for a change? In this session you will hear from museum professionals who made transitions - some radical shifts and others subtle.

MODERATOR: Julie Stein, *Emeritus Director, Burke Museum*
PRESENTERS: Aaron McCanna (Yup'ik), *Diversity, Equity, Access, Inclusion and Decolonization Manager, Burke Museum*
 Rick Noguchi, *President & CEO, California Humanities*
 Polly Olsen (Yakama), *Director of Diversity, Equity, Access, Inclusion & Decolonization / Tribal Liaison, Burke Museum*
 Micah Parzen, *CEO, Museum of Us*

12:30 PM–1:45 PM

WMA COMMUNITY LUNCH

Location: Kiva Ballroom

Fee: \$67

A celebration of the WMA Community with special guest speaker Mike Murawski, PhD, Co-Founder & Owner, Art | Nature | Place. He will discuss how museums can be more human-centered.



CONCURRENT SESSIONS 2:00 PM–3:15 PM

F1 WMA2024_415
LAHAINA RESTORATION FOUNDATION: RESPONSE, RECOVERY, RESILIENCE



LEARNING FORMAT: PASSIVE LEARNING

The Lahaina Restoration Foundation (LRF) stewards multiple historic sites and collections throughout Lahaina Town in West Maui, Hawai'i. Learn about LRF's response to the devastating August 2023 wildfire, ongoing recovery efforts for buildings and collections, and what resilience means for staff and community into the future. Attendees will have opportunities to ask questions and share their own experiences.

MODERATOR: Eric Chang, *President, Hawai'i Museums Association*
PRESENTERS: Kimberly Flook, *Deputy Executive Director, Lahaina Restoration Foundation*

F2 WMA2024_MTA#3
WHAT HAPPENS WITH THE SEARCH FAILS? REBOOTING FOR SUCCESS



LEARNING FORMAT: CONVERSATION

Executive Searches can fail for any number of reasons, often due to causes out of control of the search committee. Experienced search professional Marilyn Hoffman leads a panel of failed search survivors to discuss how to turn lemons in lemonade and put lessons learned into action for an even more effective search.

PRESENTERS: Marilyn Hoffman, *Principal, Museum Search & Reference*

F3 WMA2024_369
COLLEGIAL COLLABORATIONS BETWEEN COLLECTIONS AND FUNDRAISING



LEARNING FORMAT: ACTIVE LEARNING

The overall focus of this session is to demonstrate how collections staff and development staff can develop a true fundraising partnership. This session will help fundraisers better understand how to work closely with collections staff members to craft successful funding proposals. It will also help collections staff members communicate the community impact and visitor benefit of highly technical (and expensive) collections projects.

PRESENTERS: Ariel Weintraub, *Associate Director of Institutional Giving, Oakland Museum of California*
 Violetta Wolf, *Director, University of Arizona Alfie Norville Gem and Mineral Museum*





F4 WMA2024_397
AMERICA 250: WHAT DOES THAT MEAN IN THE WEST?



LEARNING FORMAT: CONVERSATION

In 2026, the United States will commemorate 250 years since the signing of the Declaration of Independence. What does that mean for museums in the West? Are Indigenous, Black, Asian, Pacific Islander, Latino/a/x and other stories of communities often left out of history books being told? Might this be an opportunity to share them? Attendees are invited to share their perspectives, recommendations, and engage in conversation around museums and the commemoration.

PRESENTERS: James Pepper Henry, *Director Emeritus, First Americans Museum*
 Edward Tepporn, *Executive Director, Angel Island Immigration Station Foundation*
 Rebecca Horta, *Director of Youth & Family Programs, Los Angeles County Museum of Art*
 Noelle M.K.Y. Kahanu, *Associate Specialist | Public Humanities & Native Hawaiian Programs and Acting Director, Museum Studies Graduate Certificate Program, University of Hawai'i at Manoa*
 Rosanna Sharpe, *Executive Director, REACH Museum*

F5 WMA2024_417
REFLECT AND RESTORE: FINDING MINDFULNESS FOR AUDIENCES AND STAFF



LEARNING FORMAT: ACTIVE LEARNING

Mindfulness in museums is a timely topic—from meditation programming to cultivating connections among audiences, to writing and artmaking activities, there are many opportunities for museums to provide meaningful programs that support wellness and balance for their audiences and staff. Join educators with over fifteen years' experience for a participatory session that will include activities such as slow looking, artmaking, deep discussion, and handouts

PRESENTERS:
 Elizabeth Gerber, *Senior Educator, Programs & Engagement, LACMA*
 Alicia Vogl Saenz, *Manager of Family Programs, LACMA*

12:30 PM - 1:45 PM

EXHIBIT HALL CLOSING RECEPTION

Fee: FREE

Join your colleagues for light refreshments and a visit with our corporate members. The Exhibit Hall Closing Reception is your last chance to bid on silent auction items. All proceeds benefit the WMA's and MAA's scholarship funds to help colleagues attend future Annual Meetings.

Sponsored by ERCO Lighting

Location: Grand Ballroom

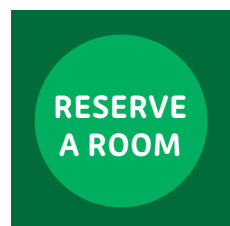

4:30 PM–6:00 PM

WMA LEADERSHIP RECEPTION

Location: TBD

INVITATION ONLY

WMA Board members, MAA Board members, Program Committee, Host Committee, and Sponsors gather for drink, food, and conversation.

Sponsored by Sunnylands Center & Gardens

6:00–7:00 PM

DINNER ON YOUR OWN

Before tonight's Evening Event, take the time to enjoy a dinner on your own, or with fellow WMA friends.

EVENING EVENT

7:00–9:30 PM

THE MINI TIME MACHINE MUSEUM OF MINIATURES

\$40 per ticket, includes beverages, food truck options, and dessert

Embark on an enchanting journey into the world of miniature artistry at The Mini Time Machine Museum of Miniatures! Immerse yourself in the Museum's newest exhibition, STAGES OF IMAGINATION: The Broadway Set Designs of David Korins, which focuses on the role of miniatures in the design process of Hamilton, Beetlejuice, Dear Evan Hanson, Here Lies Love, and The Who's Tommy. Grab a delicious bite to eat from local food trucks and a refreshing beverage from the bar. Channel your inner Broadway star with karaoke in the Enchanted Realm and dabble in the art of miniature making with Miniature Make-N-Take Kits.



8:00 AM–9:15 AM
MORNING COFFEE
 FREE!

Location: Grand Ballroom Foyer

Join your fellow Annual Meeting attendees for coffee, while connecting with new colleagues and seeing familiar faces

CONCURRENT SESSIONS 9:00 AM - 10:15 AM

G1 WMA2024_380
ELEVATE YOUR GIVING: BALANCING DATA & RELATIONSHIPS
 LEARNING FORMAT: CONVERSATION



In the realm of philanthropy, while data offers invaluable insights, it's the human touch that truly ignites support. We'll delve into the delicate dance of blending data-driven strategies with the cultivation of genuine donor connections, elevating both annual and capital giving. Discover the artistry in crafting robust donor pipelines informed by data yet fueled by heartfelt engagement. Join us in uncovering the magic where analytics and authentic relationships converge, paving the way for fundraising triumphs.

PRESENTERS: Ted Blackburn, *Managing Director, CCS Fundraising*
 Karie Birch, *Director of Development, Portland Art Museum*

G2 WMA2024_370
KE OLA NEI: LIVING MUSEUMS AND INDIGENOUS AUTHENTICITY
 LEARNING FORMAT: ACTIVE LEARNING



The International Indigenous Librarians' Forum (IILF) convened for the first time in Hawaii in November 2023. IILF opened at Waimea Valley on O'ahu where an archaeological kauhale (house site) was transformed into a living museum for Forum Delegates to explore under the direction of Native Hawaiian cultural practitioners. This talk investigates the creation of a cross-cultural, professional gathering using indigenous protocols and authentic interpretation within a context of colonial tourism and settler occupation in Hawaii,.

MODERATOR: Alyssa Purcell, *PhD Student, Graduate Assistant (Librarian) University of Hawaii at M'noa*
 (Hawai'inui kea School of Hawaiian Knowledge)

PRESENTERS: Hauolihiwahiwa Moniz, *Indigenous Initiatives Librarian, University of Hawaii at M'noa*
 (Hawaiian and Pacific Special Collections, Hamilton Library)
 Kuuleilani Reyes PhD, *Librarian, Kamehameha Schools Kaplama*
 Kainani Merrill, *Cultural Data Researcher, Nohopapa LLC*

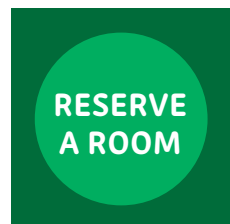

G3 WMA2024_353
10 X 10: A SESSION ABOUT BRAINSTORMING AND BUILDING CAPACITY
 LEARNING FORMAT: CONVERSATION



This session will introduce a brainstorming approach that is inclusive and collaborative. It's called 10 x 10. It's a fast and easy approach to brainstorming as a group. After an overview of the 10 x 10, we'll take the conference theme to brainstorm as a group. Examples include: How might we build capacity for ourselves? How might we build capacity for our institutions? How might we balance our passion for museum work with our capacity?

PRESENTERS: Jessica Kinsey, *Executive Director, Southern Utah Museum of Art*

G4 WMA2024_NEW2
CONDITION REPORTS FOR WORKS ON PAPER
 LEARNING FORMAT: PASSIVE LEARNING



Join your collection colleagues in reviewing and/or learning the proper way to prepare a basic condition report for works on paper. Condition reports are not only important for the management of your collection but also important documentation for your insurance broker should a damage occur. It is also best practice in collection stewardship. Works on paper may include prints, drawings; collage; manuscripts; scrolls. Basic handling and recommended storage will also be covered.

PRESENTERS: Jacqueline Cabrera, *Principal, Cabrera Art Management LLC*
 Erin Jue, *Paper Conservator, Los Angeles Art Conservation Studio*

10:15 AM–10:45 AM
COFFEE BREAK
 FREE!

Location: Grand Ballroom Foyer

Join your fellow Annual Meeting attendees for coffee, while connecting with new colleagues and seeing familiar faces.



CONCURRENT SESSIONS 10:45 AM - 12:00 PM

H1 WMA2024_345

BLAZE OF GLORY: THE HEALING FLAMES OF THE DESERT

LEARNING FORMAT: ACTIVE LEARNING

Share a mean tweet, online review, visitor comment card, performance appraisal, museum secret or wish and then drop it into the fire and let it burn!. The cleansing flames will burn away the negativity and like phoenixes (or in this case down the road from Phoenix) we will all rise from the ashes and fly into the future full of positivity and optimism!

MODERATORS: Seth Margolis, Director of Education Operations, The Museum of Flight
Molly Wilmoth, Bonnie and Oliver Steele III Curator of Education, High Desert Museum
Megumi Nagata, Heritage Program Manager, 4Culture

H2 WMA2024_422

THE ENVIRONMENTALLY CONSCIOUS MUSEUM: STRATEGIES FOR SUSTAINABILITY

LEARNING FORMAT: PASSIVE LEARNING



Museum professionals and sustainability experts will share the latest ideas and advancements in museum policy, design, and operations in environmental sustainability. Participants will learn how they can engage in these programs or take these ideas back to their institutions and begin or advance their own sustainability initiatives. Ample time will be reserved for questions allowing participants to share their experiences with the group. Presenters will provide prompting questions for the audience to engage in conversation.

PRESENTERS: Michael Fiegenschuh, Principal, EDX Exhibits
Dana Whitelaw, Executive Director, High Desert Museum

H3 WMA2024_379

STATE HUMANITIES COUNCILS AND MUSEUM ASSOCIATIONS: INTERSECTION AND COLLABORATION

LEARNING FORMAT: ACTIVE LEARNING

There are many areas of intersection between the missions and activities of state humanities councils and state museum associations. Humanities councils offer programs, grants, and access to national initiatives; state museum associations provide support services, including communication networks, professional development, and advocacy. These are often the first resources accessed by smaller museums beyond their own staff and boards. Exploring the work of both groups will expand awareness of these important museum resources, and opportunities for collaboration.

MODERATOR: Jennifer Caballero, Executive Director, California Association of Museums

PRESENTERS: Stephanie Joyner, Grants Manager, Arizona Humanities
Kristen Heidenthall, Museum Connect Project Coordinator, Washington Museums Association
Bobbie Ann Howell, Program Manager, Nevada Humanities

H4 WMA2024_376

CREATING A COLLECTIONS MODEL BASED ON INDIGENOUS NEEDS

LEARNING FORMAT: PASSIVE LEARNING



In 2021, the Cultural Resources Department at Salt River Pima-Maricopa Indian Community completed construction of a new stand-alone 24,500 square foot cultural repository to house and care for tribal collections under the direction of the Huhugam Ki: Museum. In transferring the collections from existing storage areas, the staff addressed the need to build a better collections foundation to meet the tribal priorities and objectives for a cultural repository designed by tribal members.

PRESENTERS: Franak Hilloowala, Museum Collections Manager, Huhugam Ki: Museum, Salt River Pima-Maricopa Indian Community
Gary Owens, Director/Manager, Huhugam Ki: Museum, Salt River Pima-Maricopa Indian Community

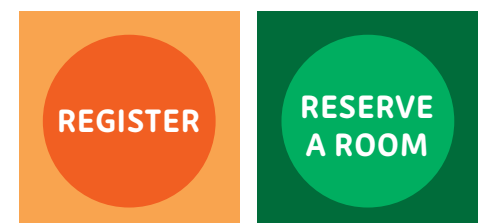



12:15 PM - 1:30 PM

AFFINITY LUNCHEONS

These events require pre-registration.

INDIGENOUS LUNCHEON

Fee: \$67 Location: TBD

Enjoy meeting your colleagues from tribal museums and supporters of Native American concerns. All are welcome! The Luncheon will feature guest speaker Jennifer Juan, Assistant Director of Community Engagement, Arizona State Museum. Discussion will follow.

Sponsored by Barona Band of Mission Indians

REGISTRAR'S COMMITTEE WESTERN REGION

Fee: \$35 Location: TBD

The Registrars Committee Western Region (RC-WR) Annual Business Meeting Luncheon is open to RC-WR members, as well as non-member Registrars, collections professionals, and related vendors.

Underwritten by Registrar's Committee Western Region

Sponsored by Collector Systems

DIRECTOR & LEADERSHIP TEAM MEMBER'S LUNCHEON

Fee: \$67 Location: TBD

This luncheon is open to Directors, Deputy Directors, CEOs, CFOs, Leadership Team Members, and Trustees. The Luncheon will feature guest speaker Jennifer Ortiz, Director of the Utah Historical Society.

STORYTELLERS AND SUPPORTERS LUNCHEON

Fee: \$67 Location: TBD

Especially for curators, development officers, editors, educators, evaluators, exhibit designers, and all who make possible the engaging stories that museums tell, but open to all. The 2024 recipient of the Charles Redd Award for Exhibit Excellence will present on the winning exhibition.

Sponsored by EDX Exhibits

1:30 PM - 3:15 PM

COFFEE KLATCH

FREE! Location: Grand Ballroom Foyer

Join your fellow Annual Meeting attendees for coffee, while connecting with new colleagues and seeing familiar faces.

12:30 PM—1:45 PM

POSTER SESSION

Location: Grand Ballroom Foyer

The perennially popular Poster Session provides opportunities for individuals to present their research, ideas, or programs through illustrated and informative posters, and they want your feedback. Come explore projects and initiatives from around the region in an informal setting.

EXHIBITION DESIGN FOR ALL: TECHNIQUES FOR ACCESSIBILITY IN THE MUSEUM

PRESENTER: Violet Rose Arma, *Curatorial Assistant & Administrative Support, University of Arizona Museum of Art*

EXHIBITS ON A SHOESTRING – HOW TO CREATE BIG MUSEUM EXHIBITS ON A SMALL MUSEUM BUDGET

PRESENTER: Michelle Reid, *Museum Services Director, Museum Pros*

ABRIENDO PUERTAS: FROM STORYTELLING TO ACTION

PRESENTER Kristine Clark, *Community Engagement Specialist, Chandler Museum*

ARIZONA ALLIANCE FOR RESPONSE

PRESENTER: Rebecca Hagen, *The Bruce Brooks Pfeiffer Director of Collections & Archives, Frank Lloyd Wright Foundation/Taliesin West*

LOCATION DILEMMA: OPPORTUNITIES AND CHALLENGES OF QUICK INVENTORY

PRESENTER: Susan Leib, *Curator of Collections, Alfie Norville Gem and Mineral Museum*

MODERN MUSEUM INTERNSHIPS 101

PRESENTER: TJ Gaudelli, *Volunteer Coordinator, Arizona Museum of Natural History*
Marisa Camarillo, *Volunteer and Community Relations Coordinator, Children's Museum of Phoenix*

ANTI-AGEISM AND LIFELONG LEARNING

PRESENTER: Melanie Fales, *Executive Director / CEO, Boise Art Museum*

2:00 PM—4:00 PM

INSPIRATION STATIONS

Location: Grand Ballroom Foyer

A showcase of ideas / solutions / innovations from around the museum field and provides your chance to talk directly with the folks making them happen. Federal agencies, museum associations, and individuals with great ideas will all be in the mix. This will be a casual way for attendees to encounter new ideas and talk to the people behind them.

PUBLISHING YOUR COLLECTIONS AND EXHIBITS: OPTIONS, CHALLENGES, CONSIDERATIONS

PRESENTER: Diane Dittmore, *Associate Curator of Ethnology, Arizona State Museum*

WASHINGTON MUSEUM ASSOCIATION

PRESENTER: Kristen Heidenthal, *Museums Connect Project Coordinator, Washington Museum Association*

SAFETY TRAININGS THAT ROCK – ENGAGE YOUR MUSEUM FOR THE NEXT GREAT SHAKEOUT

PRESENTER: Marcie Benne, *Director of Engagement Research and Advancement, Oregon Museum of Science and Industry*
Robert-Michael de Groot, *Coordinator for Communication, Education, Outreach, and Technical Engagement, USGS Earthquake Science Center*



FIELD NOTES: NATURE JOURNALING IN THE SONORAN DESERT

PRESENTERS: Larissa Mellor, Associate Director of Production, Oakland Museum of California
Alicia Goode, Preparator Supervisor, Oakland Museum of California

BALANCING ENVIRONMENTAL STEWARDSHIP AND OPERATIONAL COST IN A MUSEUM

PRESENTERS: Kathleen Fitzpatrick, Business Development Leader, DLR Group
Aaron Forbes, Culture + Performing Arts Leader, DLR Group

STEWARDSHIP OF INDIGENOUS WORK AND COLLECTIONS

PRESENTER: Dan Clevenger, Principal, Culture + Performing Arts Leader, DLR Group

2:00 PM–4:00 PM

ROUNDTABLES

Location: Grand Ballroom Foyer

COLLECTIONS ASSESSMENT FOR PRESERVATION: THE VIEW FROM THE WEST

PRESENTER: Janice Klein, Executive Director, Museum Association of Arizona

PUTTING THE NAGPRA DUTY OF CARE REGULATIONS INTO PRACTICE

PRESENTER: Lindsey Vogel-Teeter, Curator of Collections, S'edav Va'aki Museum (formerly Pueblo Grande Museum)

THE INVENTORY PROCESS AND THE SURPRISES THAT COME ALONG

PRESENTER: Michelle Sifuentes, Curator of Collections, Ontario Museum of History & Art

DIVERSITY AND INCLUSION IN COLLECTIONS DEVELOPMENT PRACTICES

PRESENTER: Melanie Tran, Chief Curator, California State Railroad Museum

ANNIVERSARY CELEBRATIONS IN THE COMMUNITY

PRESENTERS: Beverly Elliott, Executive Director, African American Museum of Southern Arizona
Shelbi Storms, Boyce Thompson Arboretum, Assistant Director

MUSEUM EDUCATORS: FINDING BALANCE

PRESENTERS: Niki Ciccotelli Stewart, Vice President of Chief Learning & Engagement Officer,
Frank Lloyd Wright Foundation | Taliesin West
Molly Wilmoth, Bonnie Lee and Oliver P. Steele III Curator of Education & Engagement, High Desert Museum

STUDENTS AS STAKEHOLDERS: STRATEGIZING SUSTAINABLE STUDENT ENGAGEMENT

PRESENTER: Lydia see, Gallery Director + Joseph Gross Endowed Curator, University of Arizona School of Art

HR CONUNDRUMS

PRESENTER: Natalie Petersen, Assistant Director, Utah Division of Arts & Museums

COFFEE WITH THE MUSEUM LAWYER

PRESENTER: Barron Oda, Principal, Invenio Legal Studio LLC

INTERNSHIPS: WHAT ARE THEY AND HOW TO DO THEM RIGHT!

PRESENTER: Aurora Hoffman, Park Ranger/Volunteer Coordinator, Arizona State Parks & Trails

ADDRESSING THE HARD QUESTIONS: APPLYING INQUIRY-BASED LEARNING ACROSS DISCIPLINES

PRESENTER: Makenzie Stewart, Volunteer Supervisor, Santa Barbara Zoo



CONCURRENT SESSIONS 3:15 PM–4:30 PM

I1 WMA2024_402
SO YOU WANT TO DO A STUDY...

LEARNING FORMAT ACTIVE LEARNING



What's in a study? What does it take? Come chat with experts in museum management, financial, and facility/exhibit planning to learn about the types of studies, and how to balance the players involved, the scopes, and the needs of an institution in the moment. Attendees will explore developing an outline style RFP with your colleagues in a small-group activity.

PRESENTERS: Andrew Nagel, Arts Facility Planner, DLR Group
John Bulla, Deputy Director/CFO, Heard Museum
Christina Kruse, Strategic & Non-Profit Financial Planning Leader, DLR Group
Janet Tam, Exhibit Designer, Reich + Petch Design

I2 WMA2024_378
ENCOUNTERING CULTURAL KNOWLEDGE IN EXHIBITION DESIGN:
CREATING WITH NATIVE PARTNERS

LEARNING FORMAT: PASSIVE LEARNING



Rather than focusing on challenges, what happens when museums view collaborations with Native communities as creative opportunities that can drive innovation? This session will use the in-progress redesign of a permanent exhibition at the High Desert Museum as a case study to illustrate how a collaborative development process with Native communities can transform exhibition strategies. Project partners will demonstrate ways that meaningful dialogue can drive new ideas and how other institutions can embrace this approach.

MODERATOR: Michelle Seiler, Assistant Director of Strategic Engagement, High Desert Museum

PRESENTERS: Phillip Cash Cash (Cayuse/Nez Perce), Linguist, Anthropologist, and Museum Advisor
Michael Holloman (Colville Confederated Tribes), Associate Professor of Fine Arts, Washington State University
Rebecca Dobkins, Curator of Native American Art, Hallie Ford Museum of Art

13 WMA2024_360

BALANCING ACT: PRESERVATION, ACCESS, AND SUSTAINABILITY

LEARNING FORMAT: CONVERSATION



The balance between collections preservation and access is familiar in theory and practice. We are now tasked to add a third element to this precarious balance: sustainability. Three panelists will discuss the challenges faced and solutions to incorporating sustainability measures in museums. The panel will consider the multifaceted meanings of sustainability including environmental and fiscal sustainability, longevity and resiliency of collections, and the museum's role in sustaining communities through environmental and social justice.

MODERATOR: Al Carver-Kubik, Senior Program Officer, National Endowment for the Humanities

PRESENTERS: Rebecca Hagen, The Bruce Brooks Pfeiffer Director of Collections and Archives, Frank Lloyd Wright Foundations, Taliesin West

Marie Desrochers, Preservation Outreach Coordinator, Utah Division of Arts & Museums

Danielle Sakowski, Program Manager, Environment and Culture Partners

14 WMA2024_400

STRENGTHS-BASED PROBLEM SOLVING: A NATURE-INFUSED JOURNEY

LEARNING FORMAT: ACTIVE LEARNING



Join us in the stunningly beautiful Tucson Desert for an immersive experience in problem solving. Step outside the conventional meeting space as we embark on a journey of self-discovery and community-building. Through personal reflection, partner discussions, and group activities, we'll tap into our strengths to tackle challenges creatively. Leave with a renewed sense of purpose, actionable plan, and a stronger network of support.

PRESENTERS: Natalie Petersen, Assistant Director, Utah Division of Arts & Museums

Lisa Solomine, Executive Director, Manoa Heritage Center

4:30-5:30PM

BREAK

Before tonight's Evening Event, take the time to enjoy a dinner on your own, or with fellow WMA friends.



EVENING EVENT

6:15 PM—9:00 PM

TUSCON MUSEUM OF ART AND HISTORIC BLOCK AND TUSCON PRESIDIO MUSEUM

\$50 per ticket, includes heavy hors d'oeuvres and beverages

Immerse yourself in Tucson's historic downtown during this combination walking tour and reception. Attendees will start at the Presidio Museum and in small, docent led groups tour the re-created Spanish Presidio. Tours will then lead attendees along the original Presidio foundation to see the Historic Pima County Courthouse, the January 8th Memorial, and many early historic homes. The walking tours will end at the Tucson Museum of Art and Historic Block to enjoy the galleries with food and drinks.

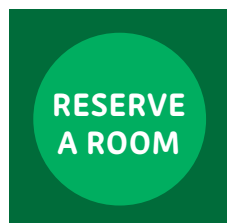

EXHIBITORS

THE BALBOA ART CONSERVATION CENTER

BPOC is a nonprofit technology and cultural strategy consultancy that offers IT managed services and strategic consulting for digital and organizational strategy, IT infrastructure, audience engagement and development, capacity building, and human capital planning to museums and other cultural organizations. We also offer institutional psychotherapy at no additional cost.

CATALOGIT

CatalogIt is a comprehensive, secure, and modern platform for cataloging and managing your collections and publishing to the web to share your objects' stories. As a cloud-based CMS, CatalogIt reduces costs and empowers staff/volunteers to collaborate simultaneously- securely viewing and editing your records anywhere, anytime from mobile or desktop.

COLLECTOR SYSTEMS

Collector Systems is a cloud-based collections management system that is Spectrum-certified and SOC 2 compliant, designed to provide users with a seamless experience in cataloging and reporting while prioritizing security. CS handles art, archives, history, archaeology, ethnology, biology, geology, and paleontology. CS mobile app is available on iOS and Android with condition reporting and barcode/QR scanning. Our API, WordPress Theme, or Plugin makes it easy to share your collections online.

DISPLAYS FINE ART SERVICES

Displays Fine Art Services is a nationwide fine arts servicer and the largest fine art service provider in the Southwest. Based in Arlington, TX, for the past 30 years, we specialize in the transportation of traveling exhibitions, museum moves, fine art transportation, storage, crate fabrication, museum furniture fabrication, and installations.

DORFMAN MUSEUM FIGURES

Dorfman Museum Figures features a broad line of artifact-appropriate, inert Ethafoam Conservation Forms for display and storage of historic uniforms, costumes, and clothing. Beyond our standard Forms, we also build unique customized bodies in both archival and non-archival materials. We also specialize in the creation of dynamic, life-sized Realistic Figures.

ERCO LIGHTING, INC.

ERCO is a leading specialist in architectural lighting, using 100% LED technology. Our luminaires are carefully developed through in-house production to offer the best quality of lighting solutions for offices, galleries, and outdoor facilities. With our extensive range of products, we offer individualized support to our customers' needs and requirements.

FRANK AMERICA, INC.

MEET FRANK A one-of-a-kind connecting system for premium, museum-quality showcases. It's unique advantages at a glance: fully demountable, emissions-free solutions, unrivaled quality, and award winning, minimalist design. "It's what's inside that counts." The perfect solution for permanent and temporary museum exhibitions of any size, FRANK protects what's precious to you.

HOLLINGER METAL EDGE

Hollinger Metal Edge has been the leading supplier of archival storage products for government and institutional archives, historical societies, museums, libraries, universities, galleries, and private collections for over 60 years. With our extremely experienced management and staff, we are dedicated to quality, customer service, and competitive prices.

LANDAU TRAVELING EXHIBITIONS

Landau Traveling Exhibitions organizes & circulates exhibitions to and for museums, universities, foundations, estates, and private collections. Since the early 1950's the Landau family has been active in the international art world, having presented more than 1,000 exhibitions at museums throughout the United States, Canada, and the world.

LORD CULTURAL RESOURCES

Lord Cultural Resources is the global practice leader in cultural sector planning. Since 1981, we have helped to create, plan, and operate cultural spaces and places in more than 460 cities. We employ a human-centric approach to all our projects, engaging with stakeholders, and communities to ensure that visitor expectations come first.

MBA DESIGN & DISPLAY PRODUCTS CORP.

mila-wall® - modular wall panel system ideal for changing exhibition spaces, multi-purpose areas and traveling exhibits. mila-wall® - flexible design, easy installation, efficient storage options. MBA offers a cost effective & sustainable panel solution.

MID-AMERICA ARTS ALLIANCE

ExhibitsUSA and NEH on the Road are traveling exhibition programs managed by Mid-America Arts Alliance, a nonprofit regional arts organization based in the heartland. Our mission is to strengthen communities and improve lives through extraordinary cultural experiences.

NORTHEAST DOCUMENT CONSERVATION CENTER

Founded in 1973, the Northeast Document Conservation Center is non-profit that specializes in the conservation of book and paper collections, digital imaging, and audio reformatting, as well as preservation training, assessments, and consultations.

STABAARTE

stabaArte has been designing, manufacturing, and installing bespoke art storage systems for museums, galleries and private collections for over 40 years. Our experienced team of engineers and architects develops custom-tailored solutions that offer the optimal storage solution for each individual collection.

STUDIO ART QUILT ASSOCIATES, INC.

Studio Art Quilt Associates, Inc. (SAQA) is a nonprofit organization whose mission is to promote the art quilt as a universally respected form of fine art. Over the past 30 years, SAQA has grown into a dynamic and active community offering exhibitions, resources, publications, and membership opportunities.

THRIVE PAYMENTS

Thrive Payments partners with museums of all sizes to design exceptional customized payment acceptance programs and services that improve the way they do business. The Thrive Payment promise is to deliver your payment processing needs simply, efficiently, and fairly. When you place your trust in Thrive Payments, we stop at nothing to outfit you with the best products available for your needs and budget. The result: your peace of mind.

TOUR-MATE

Tour-Mate is one of North-America's leading providers of fully integrated Interpretive Solutions on multiple platforms (self-guided, Group guide, and Eco friendly stationary systems). Our high quality, easy to use hardware and software, as well as our approach to content creation ensures that each visitor has a significantly enhanced visitor experience.

TRU VUE, INC.

For over 50 years, Tru Vue has created specialist glazing with protective and aesthetic characteristics that allow viewers to experience artworks as the artist intended. Optium Museum Acrylic®, TruLife® Acrylic, and UltraVue® Laminated Glass, are trusted to protect and display fine art and cultural heritage across the globe.

U.S.ART COMPANY

U.S.Art Company is one of the premier fine art handling companies in the country specializing in museum quality transportation, crating, installation, storage, international customs services, and exhibition coordination. U.S.Art offers the most extensive US shuttle network. With all of our services, safety and security are top priorities.

REGISTER

RESERVE
A ROOM



ABOUT TUCSON

The area now known as Tucson, Arizona has a long and rich history dating back to visits by the Paleo-Indians over 12,000 years ago followed by Hohokam Indians communities living here for 4,000 years before the Spanish missionaries and soldiers arrived in the late 1600s. The word Tucson is derived from the Spanish name “Tucsón” which itself originates from the O’odham word “Cuk on” and translates to “(be) black, (be) dark.” This term has more popularly been interpreted to mean “at the base of the black hill,” referencing the iconic Sentinel Peak. Even more recent names for Tucson are “The Old Pueblo” and “America’s biggest small town.”

Today, situated 108 miles southeast of Phoenix, and just 11 miles north of the United States-Mexico border, Tucson is the cultural hub of the Sonoran Desert and is considered one of the brightest cities in the United States where the sun shines 350 days of the year. The city has numerous historical neighborhoods each referencing a diverse cultural heritage such as El Presidio, Tucson’s oldest neighborhood in downtown/central Tucson. Moving to the East, you’ll find treasures such as the Saguaro National Park East and to the West Saguaro National Park West and Old Tucson Studios, the set of many famous Western films. In Northern Tucson you’ll find the headquarters of the 2024 Annual Meeting, the Loews Ventana Canyon Resort.

INVENTOR OF: THE CHIMICHANGA
INTERNATIONAL ACCLAIM: 1ST UNESCO CREATIVE CITY OF GASTRONOMY IN THE U.S.

GEOGRAPHY & CLIMATE

The greater Tucson area, on an alluvial plain in the Sonoran Desert, sits along the Santa Cruz and Rillito Rivers, sandwiched between five mountain ranges: the Santa Catalina Mountains, the Tortolita Mountains, the Santa Rita Mountains, the Rincon Mountains, and the Tucson Mountains. Tucson has a hot desert climate with two main seasons, a hot summer and mild winter. Known as having “a dry heat” the average temperature for the year is 83°, with the warmest month being June and July and the coolest being January. During late September, the month of the Annual Meeting, the temperature is an average high of 92° and an average low of 67°.



Although warmer weather is scheduled for the Annual Meeting, the conference halls can be rather chilly. We recommend layering up, bringing a jacket for the indoors and the Evening Events outside.

GETTING AROUND & TRANSPORTATION

Getting around Tucson is easy with their smart, streamlined transit system that includes shuttles, buses, and a light rail, all of which can be viewed [here](#). For a convenient way to travel around the city, hop on the Tucson Sun Link Streetcar to ride through the University of Arizona campus, the four downtown-area shopping-dining-entertainment districts, the Main Gate Square, the Mercado district, and the Congress Street district.

If you’re flying into Tucson, there are a few ways to get to the WMA 2024 headquarters hotel, the Loews Ventana Canyon Resort. Unfortunately, the hotel does NOT offer airport shuttle service, but there are other options available. If you’re coming from Tucson International Airport (TUS), you can get to WMA headquarters by Taxi, rental car, Lyft or Uber. If you’re coming from Phoenix Sky Harbor Airport (PHX) you can get to Tucson by Shuttle, Greyhound Bus, Taxi, Uber, Lyft, or a rental car.

Providing professional development to museum professionals since 1935

OUR MISSION

Strengthening museums to serve diverse communities.

OUR VISION

Dynamic museums inspiring a more just future.

WHO WE ARE

The Western Museums Association (WMA) is a nonprofit, membership organization dedicated to serving museums, museum professionals, and related institutions by providing vision, enrichment, intellectual challenge, as well as a forum for communication and interaction. Through training and educational programs, the WMA empowers the diverse museum community of the West to cultivate leadership and enable institutions to remain relevant in a dynamic world.

Additionally, the WMA creates opportunities for its constituents to build skillsets to better serve their communities through their museums by providing professional development opportunities west of the Rockies, including in Alaska and Hawaii, the western Canadian provinces of Alberta and British Columbia, among others.



CONTACT

Western Museums Association
PO Box 4738
Tulsa, OK, 74159
P: 707.433.4701
wma@westmuse.org

OUR CORE VALUES

PROGRESS AND IMPROVEMENT

WMA challenges museums — as we challenge ourselves — to keep pushing forward to grow their positive impact in their communities and in the advancement of their staffs.

RESPONSIBILITY AND STRENGTH

We believe museums have a responsibility to the communities of which they are an integral part, as we have a responsibility to museums and museum people.

LEADERSHIP AND SUSTAINABILITY

We promote professional development as a path to growing future leaders from within the field and creating new models for future success and vitality.

COLLABORATION AND OUTREACH

Through collaborative partnerships, WMA supports others in the museum field — including other associations — to strengthen the field’s capacity.

TRUST AND RECIPROCITY

We respect each other’s work and individual value as we build life-long relationships that support each other’s professional endeavors and personal well-being.

CREATIVITY AND EXPERIMENTATION

WMA serves as an incubator of ideas for the museum field through creativity in member engagement and program development.

FUN AND PLAY

We recognize that enjoyment facilitates learning, discovery, and relationship building among colleagues who energize each other to be creative problem solvers and happier people.

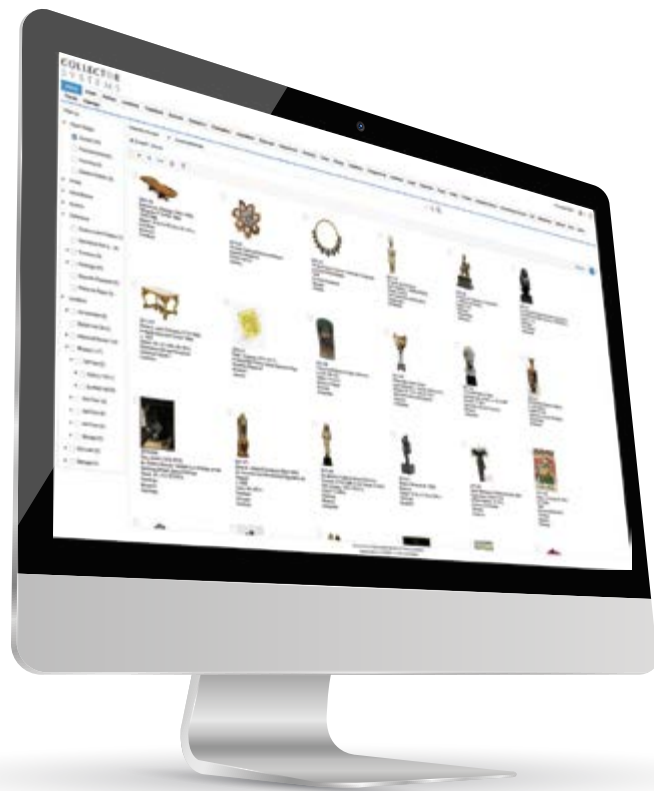

COLLECTOR SYSTEMS

cloud-based collection management software

Powerful. Intuitive. Secure.
This CMS? Best there is.
Stress level? None.

- Secure cloud-based solution
- Wordpress or Drupal Theme and Plugins
- Updated Conservation Fields
- New Framing, Lighting, and Finding Aids
- iOS/Android apps with condition reporting
- Batch location updating with barcoding
- Loans and Exhibitions
- Entry and Exit
- Accession and Deaccession

info@collectorsystems.com
 www.collectorsystems.com



Variations to a Theme: William Haines at Sunnylands
 Celebrating the world's finest collection of custom Haines furniture

THROUGH JUNE 1, 2025

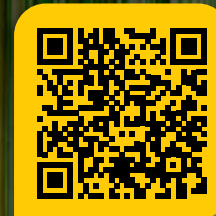

e·d|x

- Interpretive Planning
- Exhibit Design
- Graphic Design
- Interactive Media
- Research
- Signage & Wayfinding

www.edxseattle.com
 206-528-5556

Ute Indian Museum:
Our History is Written on the Land
 WINNER, NAI INTERPRETIVE MEDIA AWARDS

Photo: Will Austin



Sunnylands Center & Gardens
 8:30 – 4 Wed–Sun





Sedona Heritage MUSEUM



www.museumfigures.com
410-284-3248

Dorffman Conservation Forms created exclusively with Ethafoam® brand inert polyethylene foam.

Explore the unique history of **Sedona** and Arizona's breathtaking **Red Rock Country!**





'Eyay 'Ehan, Western Museums Association! Peyii 'Enyeway 'Esekaayches!



ELEVATE *the* HUMAN EXPERIENCE
THROUGH DESIGN

